

# Submittal Data Sheet

In-line Centrifugal Pumps



## Wilo-IL 3-150 - 3-170 (2 Pole)



Project:	
Engineer:	
Contractor:	
Submitted By:	Date:
Approved By:	Date:

Tag #	Model #	Flow	Head	HP	Cycle	Phase	Voltage	RPM
					60Hz			3500

### Product Info

Brand	Wilo
Product Description	IL 3-150 - IL 3-170

### Construction Materials

Pump Volute	Cast Iron EN-GJL-250
Impeller	Bronze (cast iron optional)
Shaft	316L stainless steel
Mechanical Seal	Q1Q1X4GG (silicium carbide seal faces, HNBR elastomers)

### Motor Data

Power Supply	1~115/208-230 volt 3~208-230/460, 575 volt
Integrated full motor protection	integrated protection PTC/PTO on request (on-site trip unit required)
Protection Class	TEFC (ODP on request)
Insulation Class	F

### Hydraulic Data

Flange Connection	3" 125# ANSI compatible with 1/4" pressure gauge tappings
Max Operating Pressure	175 PSI (12 bar)
Min. Fluid Temp	-5°F (-20 °C)
Max Fluid Temp	285°F (140 °C)
Max. Ambient Temp	104°F (40 °C)

### Application

- Hot water heating systems
- Air conditioning systems
- Closed cooling circuits
- Industrial circulation systems
- Solar Systems
- Geothermal Systems

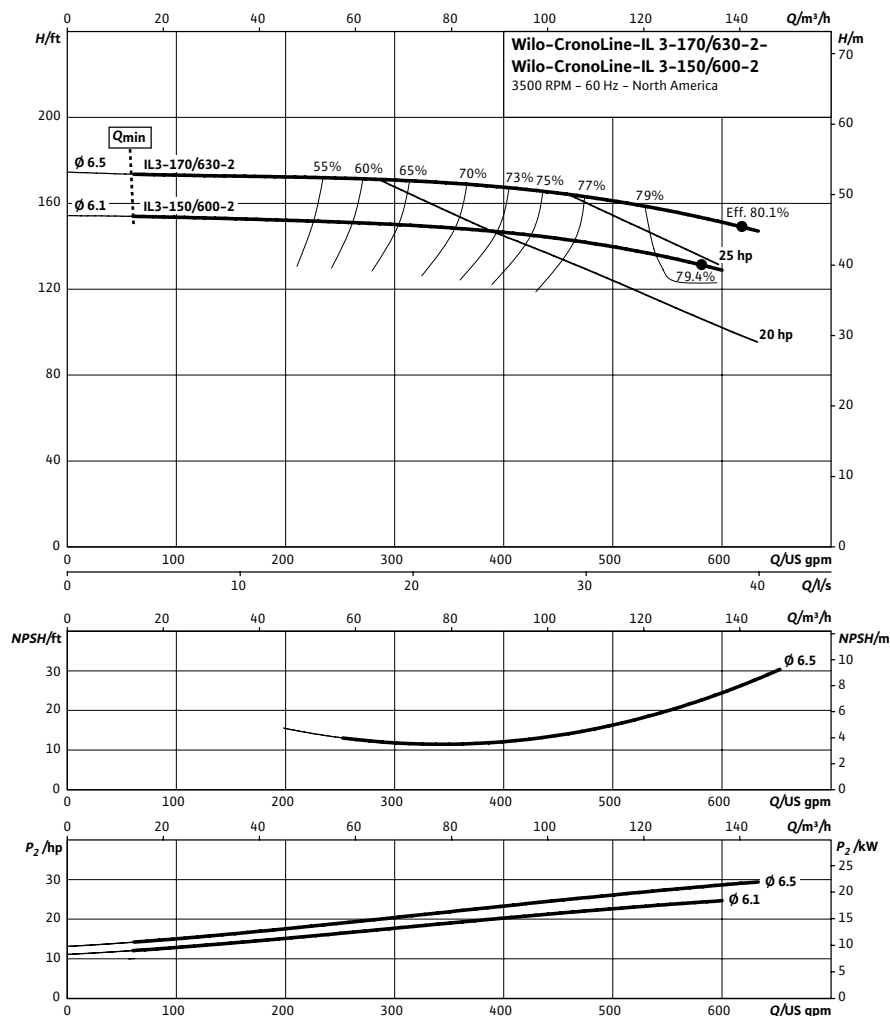

Approval Stamp

# Submittal Data Sheet

In-line Centrifugal Pumps



## Dimensions & Weights

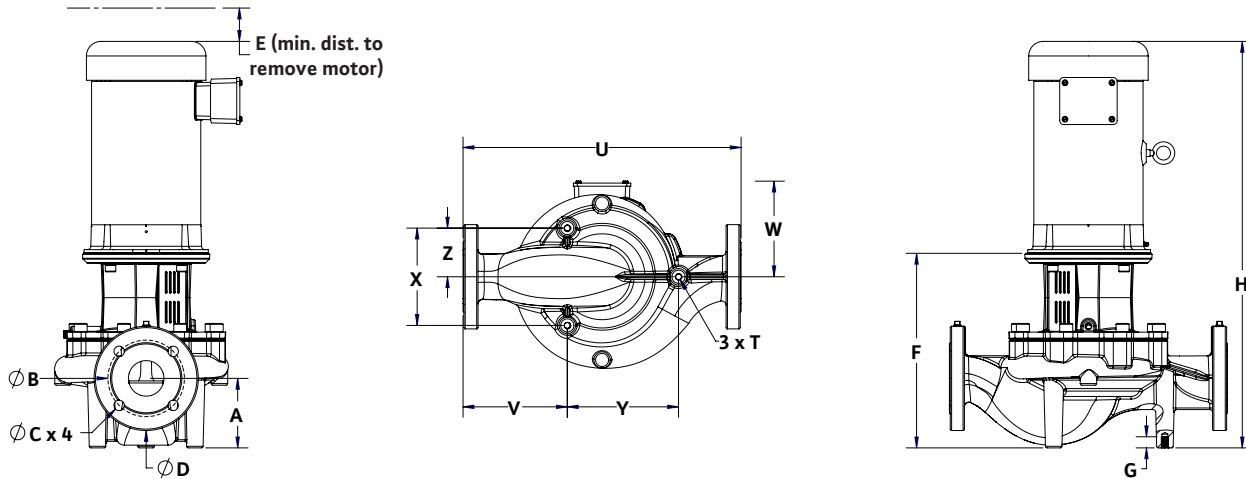

## Dimensions and Weights

Model	PEI	Voltage		P2	Phase	Dimensions (in)													Weight lbs
		[V]	Motor			[HP]	[~]	Dia	A	E	F	G	H	T	U	V	W	X	
IL 3-150/600-2	0.95	208/230-460	TEFC	25	3	3.00	4.84	3.25	13.83	0.79	33.02	1/2"-13	19	7.6	11.52	7.09	7.87	3.55	458
		575	TEFC	25	3	3.00	4.84	3.25	13.83	0.79	37.18	1/2"-13	19	7.6	11.08	7.09	7.87	3.55	522
IL 3-170/630-2	0.95	208/230-460	TEFC	30	3	3.00	4.84	3.25	13.83	0.79	33.02	1/2"-13	19	7.6	11.52	7.09	7.87	3.55	528
		208/230-460	ODP	30	3	3.00	4.84	3.25	13.83	0.79	35.5	1/2"-13	19	7.6	12.21	7.09	7.87	3.55	460
	575	TEFC	30	3	3.00	4.84	3.25	13.83	0.79	37.18	1/2"-13	19	7.6	11.08	7.09	7.87	3.55	541	
	575	ODP	30	3	3.00	4.84	3.25	13.83	0.79	32.42	1/2"-13	19	7.6	11.93	7.09	7.87	3.55	443	

## Flange Dimensions

Dimensions - Inches		
ØB	ØC x 4	ØD
6	0.75 x 4	8.25