

Submittal Data Sheet

In-line Centrifugal Pumps



Wilo-IL 3-220 - 3-290 (2 Pole)



Project:	
Engineer:	
Contractor:	
Submitted By:	Date:
Approved By:	Date:

Tag #	Model #	Flow	Head	HP	Cycle	Phase	Voltage	RPM
					60Hz			3500

Product Info

Brand	Wilo
Product Description	IL 3-220 - IL 3-290

Construction Materials

Pump Volute	Cast Iron EN-GJL-250
Impeller	Bronze (cast iron optional)
Shaft	316L stainless steel
Mechanical Seal	Q1Q1X4GG (silicium carbide seal faces, HNBR elastomers)

Motor Data

Power Supply	1~115/208-230 volt 3~208-230/460, 575 volt
Integrated full motor protection	integrated protection PTC/PTO on request (on-site trip unit required)
Protection Class	TEFC (ODP on request)
Insulation Class	F

Hydraulic Data

Flange Connection	3" 125# ANSI compatible with 1/4" pressure gauge tappings
Max Operating Pressure	175 PSI (12 bar)
Min. Fluid Temp	-5°F (-20 °C)
Max Fluid Temp	285°F (140 °C)
Max. Ambient Temp	104°F (40 °C)

Application

- Hot water heating systems
- Air conditioning systems
- Closed cooling circuits
- Industrial circulation systems
- Solar Systems
- Geothermal Systems

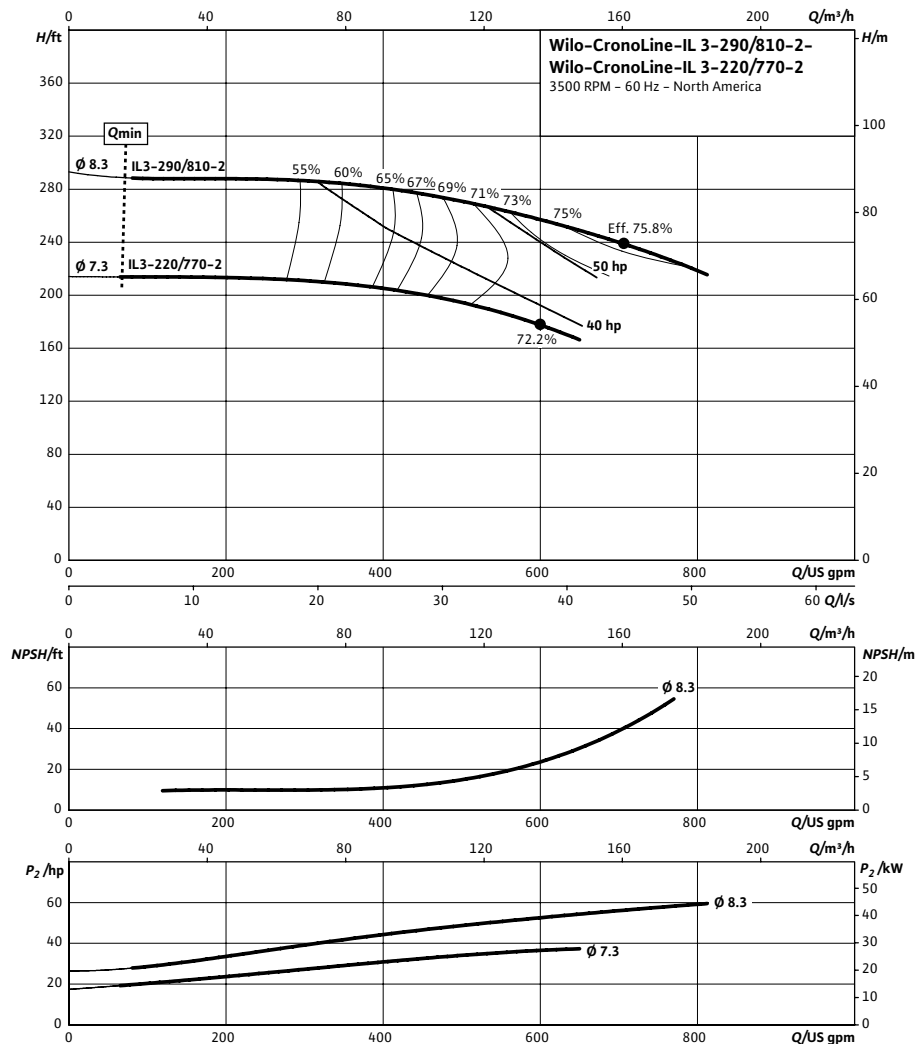

Approval Stamp

Dimensions & Weights

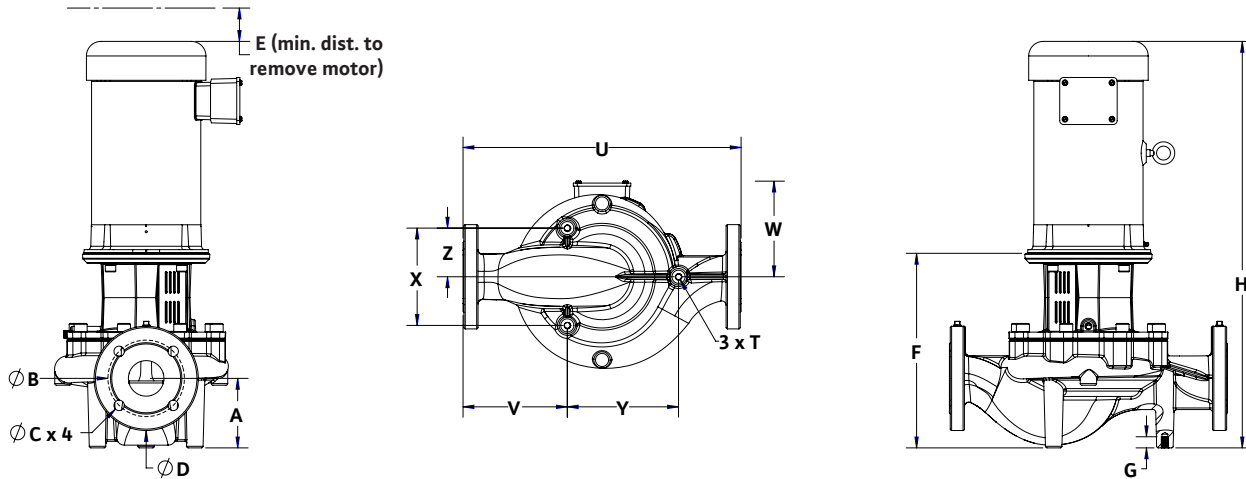

Dimensions and Weights

Model	PEI	Voltage		P2	Phase	Dia	Dimensions (in)											Weight lbs	
		[V]	Motor				A	E	F	G	H	T	U	V	W	X	Y		Z
IL 3-220/770-2	0.99	208/230-460	TEFC	40	3	3.00	5.71	3.75	15.83	0.79	40.91	1/2"-13	21	8.87	13.74	8.66	9.13	4.33	639
		575	TEFC	40	3	3.00	5.71	3.75	15.83	0.79	41.73	1/2"-13	21	8.87	12.58	8.66	9.13	4.33	734
IL 3-290/810-2	0.97	208/230-460	TEFC	60	3	3.00	5.71	3.75	15.83	0.79	43.75	1/2"-13	21	8.87	18.1	8.66	9.13	4.33	999
		208/230-460	ODP	60	3	3.00	5.71	3.75	15.83	0.79	44.47	1/2"-13	21	8.87	16.02	8.66	9.13	4.33	1046
	575	TEFC	60	3	3.00	5.71	3.75	15.83	0.79	37.94	1/2"-13	21	8.87	13.39	8.66	9.13	4.33	656	
		ODP	60	3	3.00	5.71	3.75	15.83	0.79	37.94	1/2"-13	21	8.87	13.39	8.66	9.13	4.33	669	

Flange Dimensions

Dimensions - Inches		
ØB	ØC x 4	ØD
6	0.75 x 4	8.25