

Wilo-Stratos MAXO-Z

		Project:					
		Engineer:					
		Contractor:					
		Submitted By:			Date:		
		Approved By:			Date:		
Tag #	Model #	Flow	Head	Control Mode	Cycle	Phase	Voltage
	Maxo-Z 1.25x3-25				60Hz	1~	115/230-240V

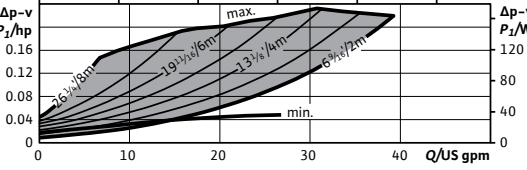
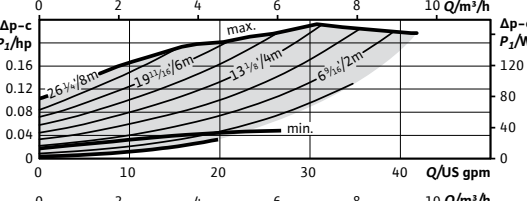
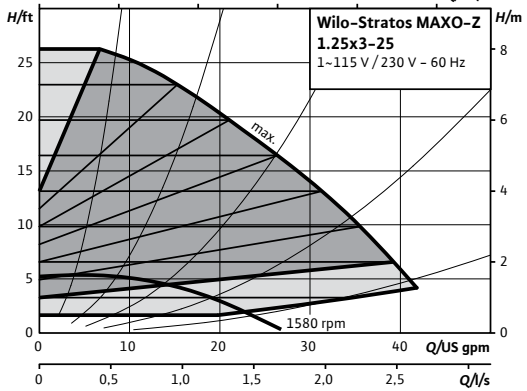
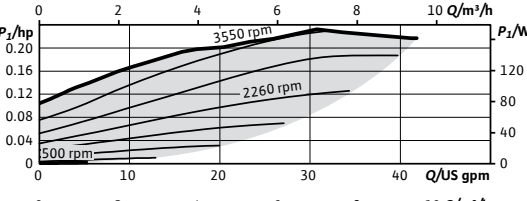
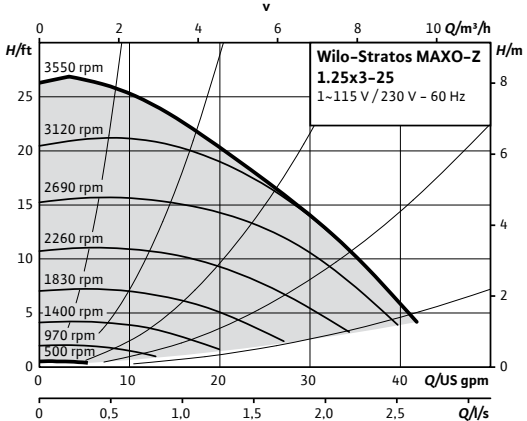

Product Info

Brand	Wilo
Product Description	Stratos MAXO-Z 1.25x3-25
Article Number	2164623
Net Weight (approx.)	16 lbs

Hydraulic Data

Max Operating Pressure PN	145 PSI
Min. Suction Head (122°F)	4.3 PSI
Min. Suction Head (176°F)	11.4 PSI
Min. Suction Head (203°F)	14.2 PSI
Min. Suction Head (230°F)	22.8 PSI
Min. Fluid Temp for SHW T	32°F
Max Fluid Temp for SHW T	176°F
Min. Fluid Temp for HVAC T	14°F
Max Fluid Temp for HVAC T	230°F
Min. Ambient Temp (SHW T)	32°F
Max. Ambient Temp (SHW T)	104°F
Min. Ambient Temp (HVAC T)	14°F
Max. Ambient Temp (HVAC T)	104°F

CIF Module Selection

- BACnet MS/TP
- Modbus RTU
- CANopen
- LON TP/FT-10
- PLR

Accessory Selection

- Immersion Temp. Sensor Pt 1000 AA
- Immersion Sleeve G 1/2", 45mm
- Pipe Surface Contact Sensor PT 1000 B
- Immersion Sleeve G 1/2", 100mm

Materials

Pump Housing	1.4408
Impeller	PPS-GF40
Shaft	1.4122
Bearing	Carbon-graphite

Motor Data

Mains Connection	1~115 ±10%, 50/60Hz 1~230-240V ±10%, 50/60Hz
Motor Type	ECM
Rated Power P ₂	0.178 hp
Min. Speed n _{min}	500 RPM
Max. Speed n _{max}	3550 RPM
Power Consumption P _{1,max}	0.233 hp
Power Consumption P _{1,min}	0.009 hp
Max Current (1~230V) I _{max}	0.76 A
Min Current (1~230V) I _{min}	0.11 A
Max Current (1~115V) I _{max}	1.53 A
Min Current (1~115V) I _{min}	0.11 A
Insulation Class	F
Protection Class	Enclosure 2

Electrical Inputs

Analog Inputs (2x)	0-10V / 0-20mA / 4-20mA / PT 1000 Passive/Active +24V DC
Digital Inputs (2x)	Ext Off / Ext Min / Ext Max / Ext. MANUAL (BMS off) / External Key Lock / Switch heating, cooling
Wilo NET	Multi-Pump Communication
SSM	Fault Signal
SBM	Run Signal

Installation Dimensions

- Pipe Connection (discharge) 1 1/4"
- Pipe Connection (suction) 1 1/4"
- Flange to Flange 6 1/2"

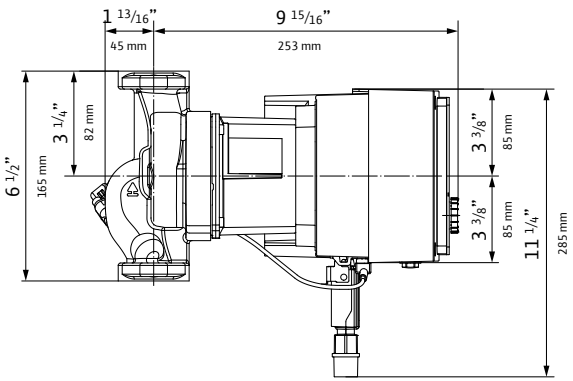
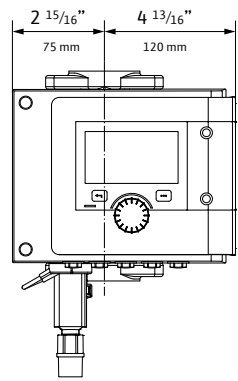
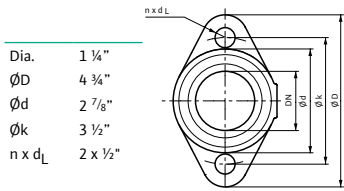

WILO USA LLC
+1 262-204-6600
www.wilo-usa.com
info.us@wilo.com

WILO Canada Inc.
+1 403-276-9456
www.wilo-canada.com
info@wilo-canada.com

WILO Mexico
+52 442 167 00 32
www.wilo-mexico.com
info@wilo.com.mx

Wilo-Stratos MAXO-Z

		Project:					
		Engineer:					
		Contractor:					
		Submitted By:			Date:		
		Approved By:			Date:		
Tag #	Model #	Flow	Head	Control Mode	Cycle	Phase	Voltage
	Maxo-Z 1.25x3-35				60Hz	1~	115/230-240V

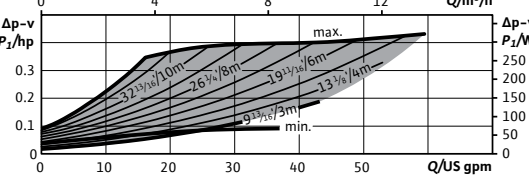
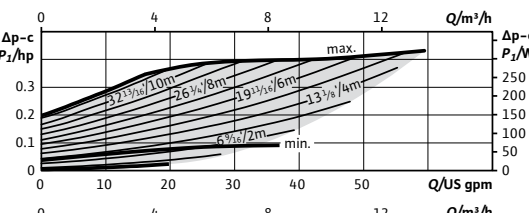
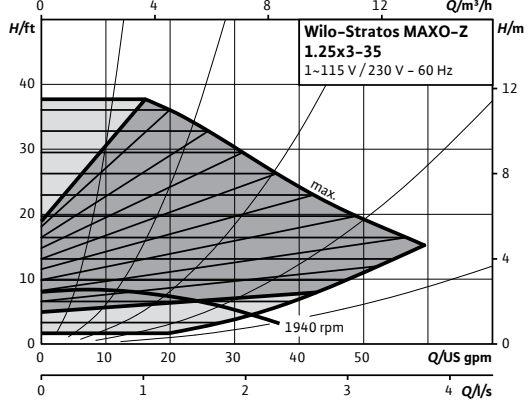
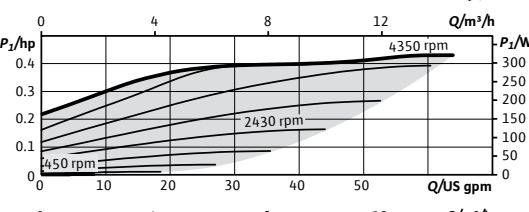
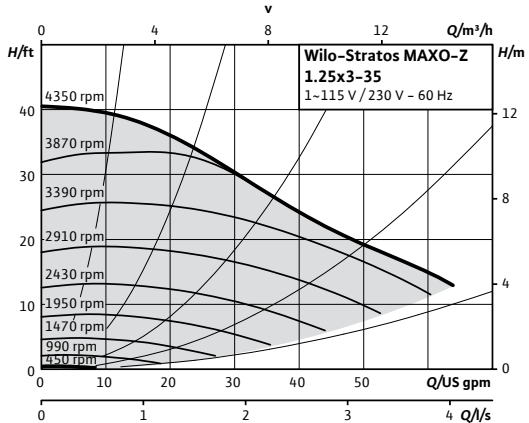

Product Info

Brand	Wilo
Product Description	Stratos MAXO-Z 1.25x3-35
Article Number	2164624
Net Weight (approx.)	34 lbs

Hydraulic Data

Max Operating Pressure PN	145 PSI
Min. Suction Head (122°F)	4.3 PSI
Min. Suction Head (176°F)	11.4 PSI
Min. Suction Head (203°F)	14.2 PSI
Min. Suction Head (230°F)	22.8 PSI
Min. Fluid Temp for SHW T	32°F
Max Fluid Temp for SHW T	176°F
Min. Fluid Temp for HVAC T	14°F
Max Fluid Temp for HVAC T	230°F
Min. Ambient Temp (SHW T)	32°F
Max. Ambient Temp (SHW T)	104°F
Min. Ambient Temp (HVAC T)	14°F
Max. Ambient Temp (HVAC T)	104°F

CIF Module Selection

- BACnet MS/TP
- Modbus RTU
- CANopen
- LON TP/FT-10
- PLR

Accessory Selection

- Immersion Temp. Sensor Pt 1000 AA
- Immersion Sleeve G 1/2", 45mm
- Pipe Surface Contact Sensor PT 1000 B
- Immersion Sleeve G 1/2", 100mm

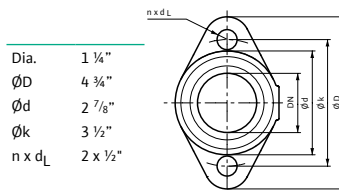

Materials

Pump Housing	1.4408
Impeller	PPS-GF40
Shaft	1.4122, DLC-coated
Bearing	Carbon-graphite

Motor Data

Mains Connection	1-115 ±10%, 50/60Hz 1-230-240V ±10%, 50/60Hz
Motor Type	ECM
Rated Power P ₂	0.354 hp
Min. Speed n _{min}	450 RPM
Max. Speed n _{max}	4350 RPM
Power Consumption P _{1,max}	0.433 hp
Power Consumption P _{1,min}	0.013 hp
Max Current (1-230V) I _{max}	1.38 A
Min Current (1-230V) I _{min}	0.15 A
Max Current (1-115V) I _{max}	2.83 A
Min Current (1-115V) I _{min}	0.15 A
Insulation Class	F
Protection Class	Enclosure 2

Electrical Inputs

Analog Inputs (2x)	0-10V / 0-20mA / 4-20mA / PT 1000 Passive/Active +24V DC
Digital Inputs (2x)	Ext Off / Ext Min / Ext Max / Ext. MANUAL (BMS off) / External Key Lock / Switch heating, cooling
Wilo NET	Multi-Pump Communication
SSM	Fault Signal
SBM	Run Signal

Installation Dimensions

Pipe Connection (discharge)	1 1/4"
Pipe Connection (suction)	1 1/4"
Flange to Flange	8 1/2"

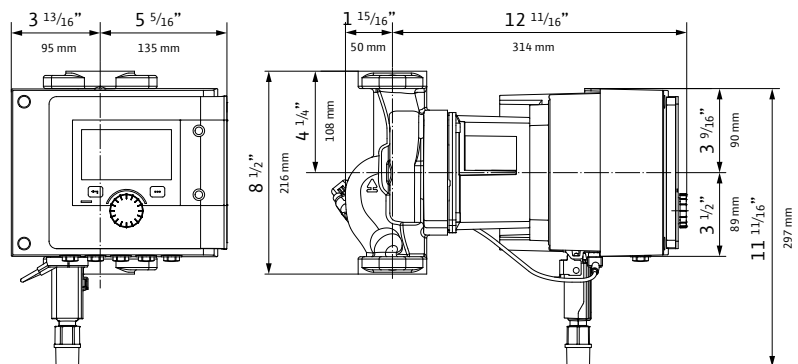

WILO USA LLC
+1 262-204-6600
www.wilo-usa.com
info.us@wilo.com

WILO Canada Inc.
+1 403-276-9456
www.wilo-canada.com
info@wilo-canada.com

WILO Mexico
+52 442 167 00 32
www.wilo-mexico.com
info@wilo.com.mx

Wilo-Stratos MAXO-Z

		Project:					
		Engineer:					
		Contractor:					
		Submitted By:			Date:		
		Approved By:			Date:		
Tag #	Model #	Flow	Head	Control Mode	Cycle	Phase	Voltage
	Maxo-Z 2x3-35				60Hz	1~	230-240V

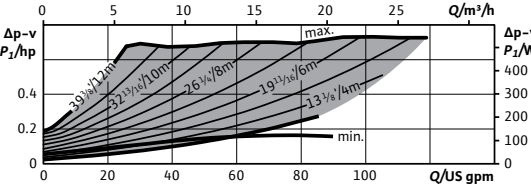
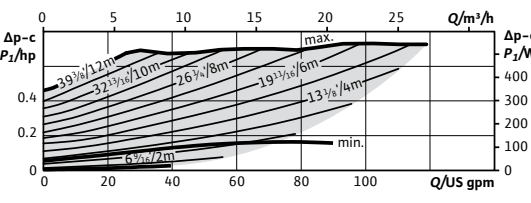
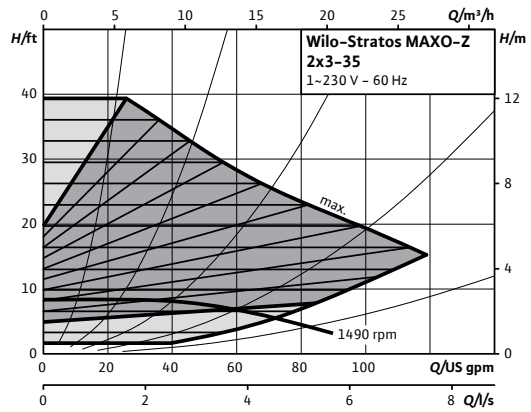
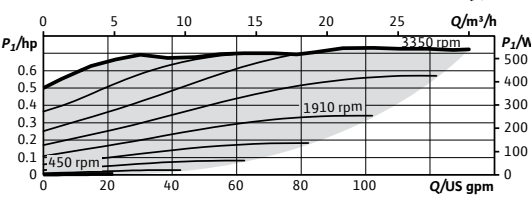
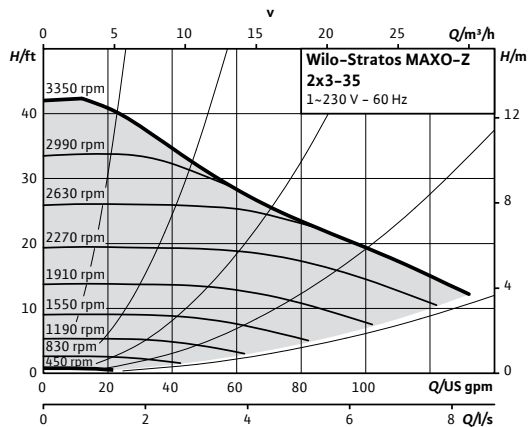

Product Info

Brand	Wilo
Product Description	Stratos MAXO-Z 2x3-35
Article Number	2164625
Net Weight (approx.)	41 lbs

Hydraulic Data

Max Operating Pressure PN	145 PSI
Min. Suction Head (122°F)	7.1 PSI
Min. Suction Head (176°F)	14.2 PSI
Min. Suction Head (203°F)	17.1 PSI
Min. Suction Head (230°F)	25.6 PSI
Min. Fluid Temp for SHW T	32°F
Max Fluid Temp for SHW T	176°F
Min. Fluid Temp for HVAC T	14°F
Max Fluid Temp for HVAC T	230°F
Min. Ambient Temp (SHW T)	32°F
Max. Ambient Temp (SHW T)	104°F
Min. Ambient Temp (HVAC T)	14°F
Max. Ambient Temp (HVAC T)	104°F

CIF Module Selection

BACnet MS/TP	
Modbus RTU	
CANopen	
LON TP/FT-10	
PLR	

Accessory Selection

Immersion Temp. Sensor Pt 1000 AA	
Immersion Sleeve G 1/2", 45mm	
Pipe Surface Contact Sensor PT 1000 B	
Immersion Sleeve G 1/2", 100mm	

Di.a.	2"
øD	5 1/4"
ød	3 7/16"
øk	4"
n x d _L	4 x 9/16"

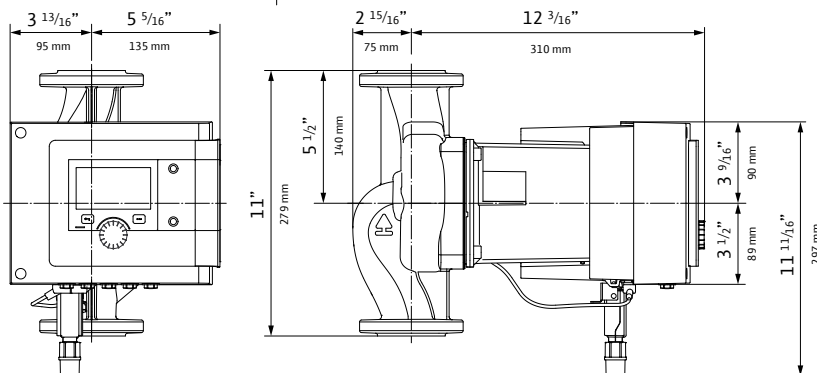
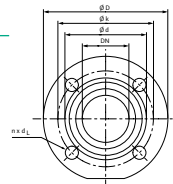

Materials

Pump Housing	1.4408
Impeller	PPS-GF40
Shaft	1.4122, DLC-coated
Bearing	Carbon-graphite

Motor Data

Mains Connection	1-230-240V ±10%, 50/60Hz
Motor Type	ECM
Rated Power P ₂	0.652 hp
Min. Speed n _{min}	450 RPM
Max. Speed n _{max}	3550 RPM
Power Consumption P _{1,max}	0.734 hp
Power Consumption P _{1,min}	0.013 hp
Max Current (1-230V) I _{max}	2.39 A
Min Current (1-230V) I _{min}	0.2 A
Insulation Class	F
Protection Class	Enclosure 2

Electrical Inputs

Analog Inputs (2x)	0-10V / 0-20mA / 4-20mA / PT 1000 Passive/Active +24V DC
Digital Inputs (2x)	Ext Off / Ext Min / Ext Max / Ext. MANUAL (BMS off) / External Key Lock / Switch heating, cooling
Wilo NET	Multi-Pump Communication
SSM	Fault Signal
SBM	Run Signal

Installation Dimensions

Pipe Connection (discharge)	2"
Pipe Connection (suction)	2"
Flange to Flange	11"

Wilo-Stratos MAXO-Z



Project:	
Engineer:	
Contractor:	
Submitted By:	Date:
Approved By:	Date:

Tag #	Model #	Flow	Head	Control Mode	Cycle	Phase	Voltage
	Maxo-Z 3x3-40				60Hz	1~	230-240V

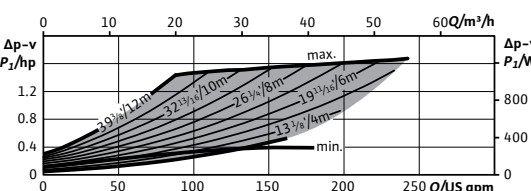
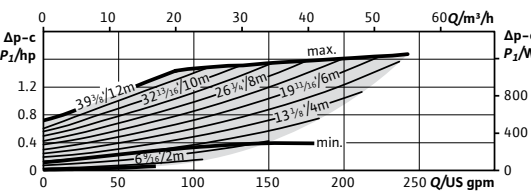
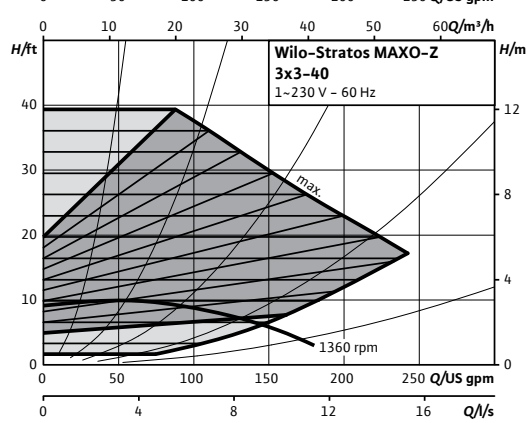
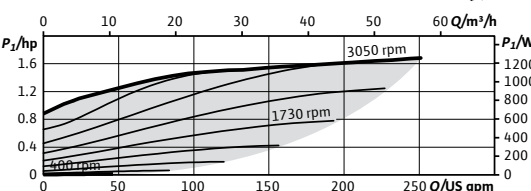
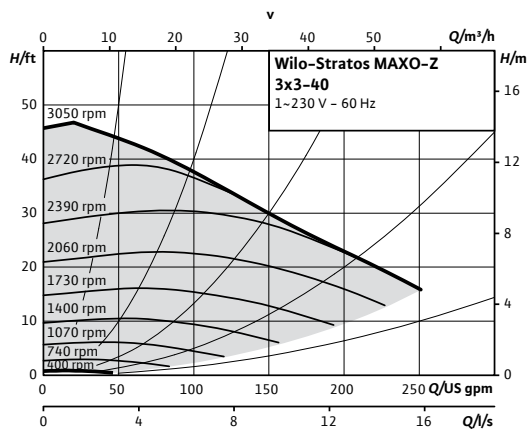

Product Info

Brand	Wilo
Product Description	Stratos MAXO-Z 3x3-40
Article Number	2164626
Net Weight (approx.)	72 lbs

Hydraulic Data

Max Operating Pressure PN	145 PSI
Min. Suction Head (122°F)	10.0 PSI
Min. Suction Head (176°F)	17.1 PSI
Min. Suction Head (203°F)	21.3 PSI
Min. Suction Head (230°F)	32.7 PSI
Min. Fluid Temp for SHW T	32°F
Max Fluid Temp for SHW T	176°F
Min. Fluid Temp for HVAC T	14°F
Max Fluid Temp for HVAC T	230°F
Min. Ambient Temp (SHW T)	32°F
Max. Ambient Temp (SHW T)	104°F
Min. Ambient Temp (HVAC T)	14°F
Max. Ambient Temp (HVAC T)	104°F

CIF Module Selection

BACnet MS/TP
Modbus RTU
CANopen
LON TP/FT-10
PLR

Accessory Selection

Immersion Temp. Sensor Pt 1000 AA
Immersion Sleeve G 1/2", 45mm
Pipe Surface Contact Sensor PT 1000 B
Immersion Sleeve G 1/2", 100mm

Materials

Pump Housing	1.4408
Impeller	PPS-GF40
Shaft	1.4122, DLC-coated
Bearing	Carbon-graphite

Motor Data

Mains Connection	1-230-240V ±10%, 50/60Hz
Motor Type	ECM
Rated Power P ₂	1.641 hp
Min. Speed n _{min}	400 RPM
Max. Speed n _{max}	3050 RPM
Power Consumption P _{1,max}	1.810 hp
Power Consumption P _{1,min}	0.020 hp
Max Current (1-230V) I _{max}	5.88 A
Min Current (1-230V) I _{min}	0.3 A
Insulation Class	F
Protection Class	Enclosure 2

Electrical Inputs

Analog Inputs (2x)	0-10V / 0-20mA / 4-20mA / PT 1000 Passive/Active +24V DC
Digital Inputs (2x)	Ext Off / Ext Min / Ext Max / Ext. MANUAL (BMS off) / External Key Lock / Switch heating, cooling Multi-Pump Communication
Wilo NET	
SSM	Fault Signal
SBM	Run Signal

Installation Dimensions

Pipe Connection (discharge)	3"
Pipe Connection (suction)	3"
Flange to Flange	14"

Dia.	3"
ØD	7 9/16"
Ød	5 1/16"
Øk	6"
n x d _L	4 x 3/4"

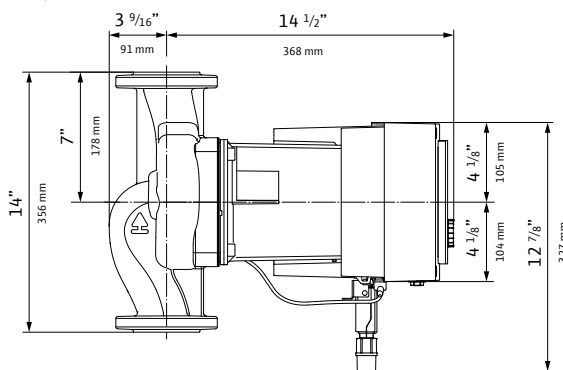
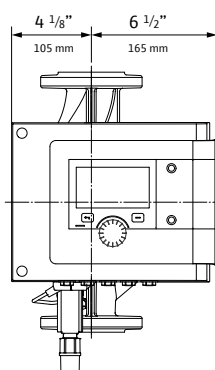
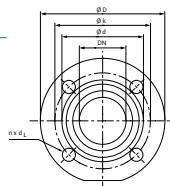

WILO USA LLC
+1 262-204-6600
www.wilo-usa.com
info.us@wilo.com

WILO Canada Inc.
+1 403-276-9456
www.wilo-canada.com
info@wilo-canada.com

WILO Mexico
+52 442 167 00 32
www.wilo-mexico.com
info@wilo.com.mx