

Zubehör - Accessories - Accessoires

Maxiprop TR226-3 + Megaprop TR326-3

AVM...

wilo

Heimgartenstraße 1-3 D-95030 Hof/Saale
 Telefon +49 9281 974-0 Fax +49 9281 96528
 www.wilo.com E-Mail: info@wilo.com

Kunde Projekt Angebot - Quotation - Offre
 Customer Project Auftrag - Order - Commande
 Client Nr. - No.:

Führungsrohrlänge Standard L= 6 m
 Guide pipe length L1= L2= L3= m
 Longueur du tube de guidage

Teile - parts - pièces séparées
 montiert - mounted - monté

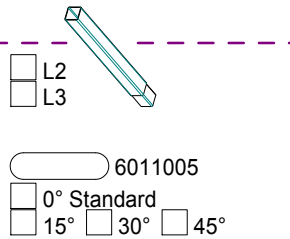
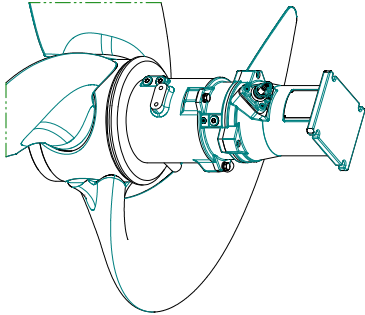

AVMSH

KMAT 6000554

AVMSH 100

A2
 A4

AVMSH 120

A4

6010954 (3x)

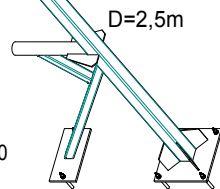

AVMS

KMAT 6000554

AVMS 100

A2
 A4

AVMS 120

A4

6010954 (3x)

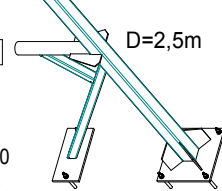

Schub
Thrust <2500N L_{max} 6m
Poussée

Schub
Thrust <5300N L_{max} 6m
Poussée

A4 = 1.4571 / AISI 316Ti / Z 6 CNDT 17-12

A2 = 1.4301 / AISI 304 / Z 7 CN 18-09

= Befestigungssatz / fixing elements / éléments de fixation

TR X26

TR 226-3. - /
 KMAT 6065962

TR 326-3. - /
 KMAT 6065961

6068158 (6068160...64)

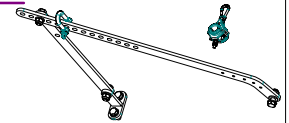

6010983

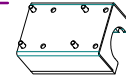

6010963 Gr.100
 6011040 Gr.120

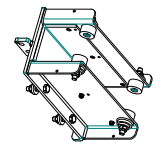

6010947 #1 (Ø10-17)
 6010946 #2 (Ø17-26)
 6011029 #3 (Ø26-36)
 6061714 #1+3
 6061715 #2+3

6068158 (6068160...64)

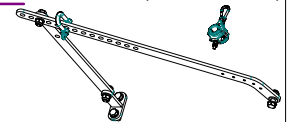

6010983

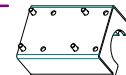

6010970 Gr.100
 6001961 Gr.120

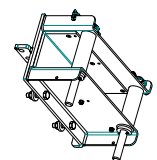

6010963 Gr.100
 6011040 Gr.120

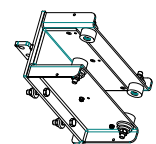

6010947 #1 (Ø10-17)
 6010946 #2 (Ø17-26)
 6011029 #3 (Ø26-36)
 6061714 #1+3
 6061715 #2+3