



A WILO COMPANY

MOTORPUMP™ — 2900 RPM

Iron, 60 Hz, 3 X 3 X 5.63 NPT

15 JM



Motor Dimensions										
HP	NEMA Type	Premium Efficient Frame	D	E	F	JM Frame O	3 Phase AB	2900 RPM BG	L	MH
1.5	ODP	JM145	3.50	2.75	2.00	6.72	5.87	4.75	5.08	0.34
2	ODP	JM145	3.50	2.75	2.00	6.72	5.87	5.25	4.97	0.34
3	ODP	JM182	4.50	3.75	2.25	8.56	6.70	5.75	6.25	0.41
5	ODP	JM184	4.50	3.75	2.25	8.56	6.70	6.25	6.15	0.41
7.5	ODP	JM213	5.25	4.25	2.75	10.14	7.97	7.97	6.60	0.41
1.5	TEFC	JM145	3.50	2.75	2.50	7.00	6.25	5.06	6.34	0.34
2	TEFC	JM182	4.50	3.75	2.25	8.85	7.57	5.01	7.14	0.41
3, 5	TEFC	JM184	4.50	3.75	2.25	9.34	7.57	5.51	7.64	0.41
7.5	TEFC	JM215	5.25	4.25	3.50	10.37	8.19	6.77	9.16	0.41

Dimensions are the next larger 60Hz motor derated for 50HZ operation.

DRAWING DEPICTS 184JM 7.5HP ODP MOTOR
ALL DIMENSIONS IN INCHES

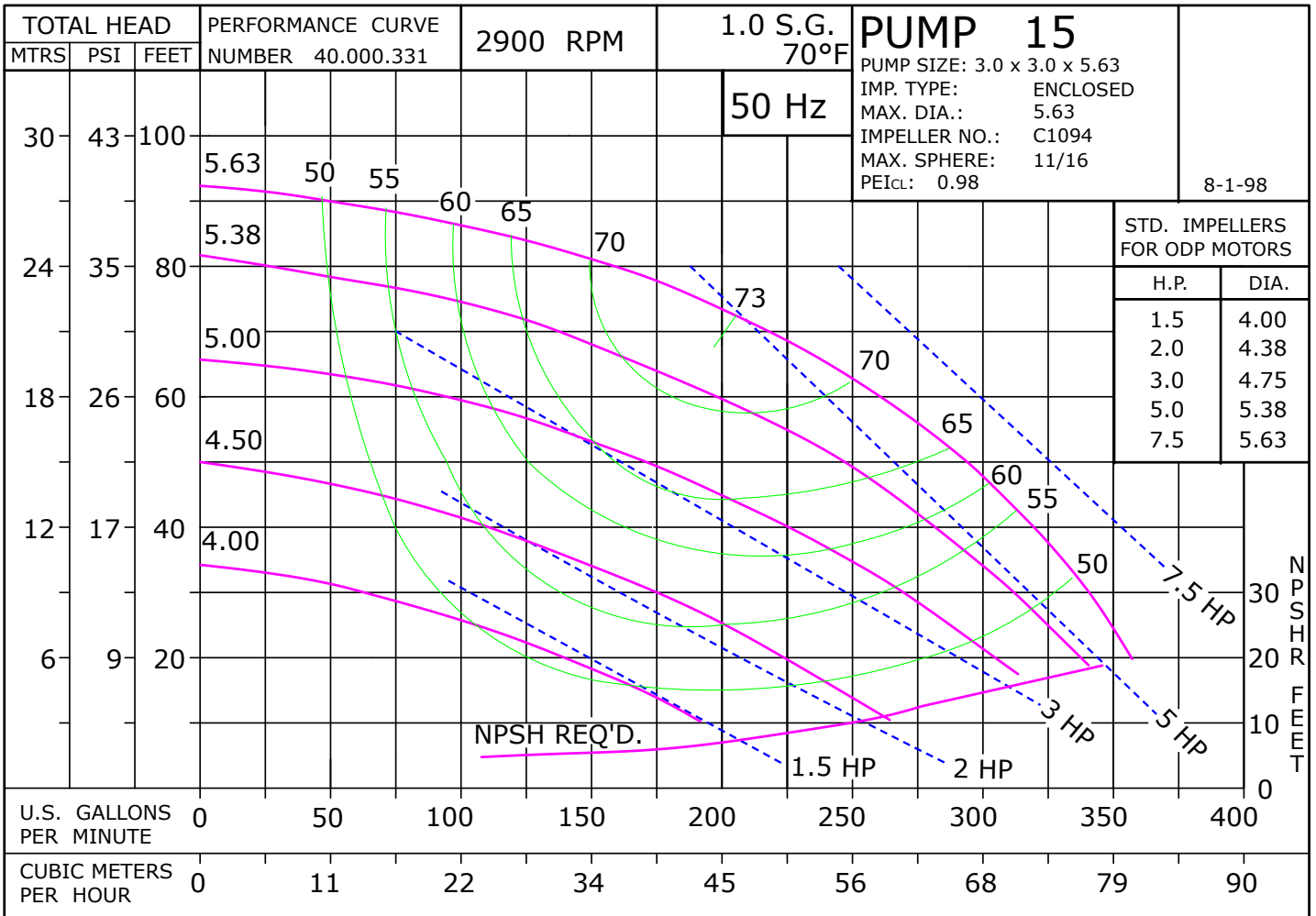
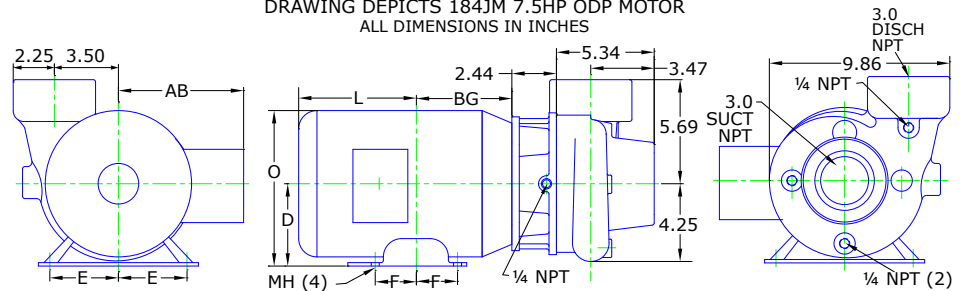

Parts

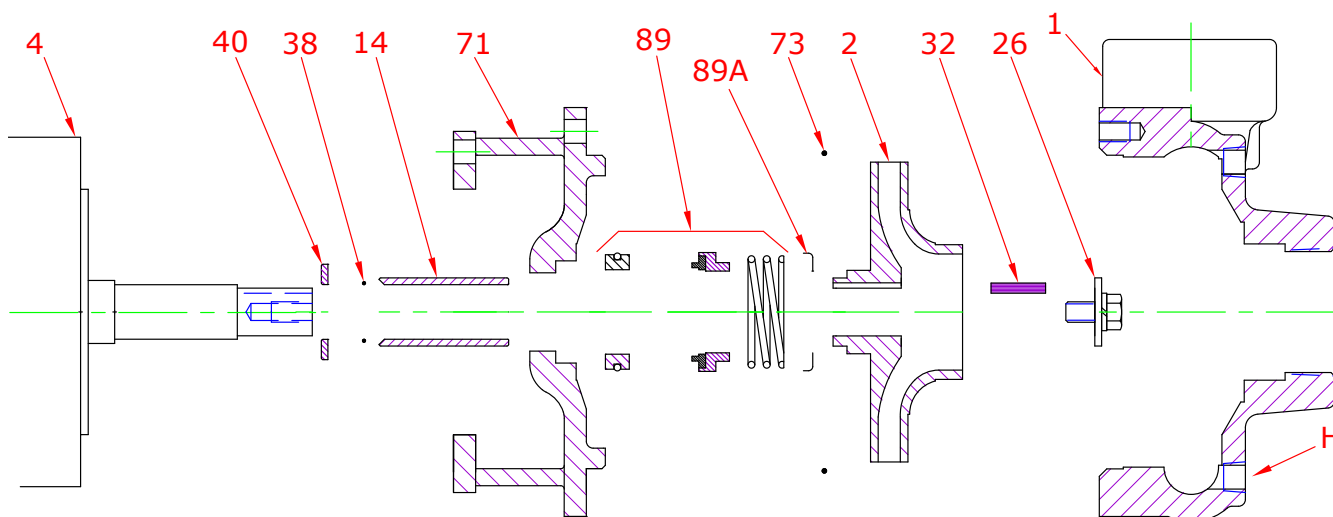

Key No.	Part Name	Part Number
1	Case 15/25, Iron, 3.00 X 3.00 NPT Brass plugs	130.000.224X
2	Impeller 15, Iron, Tefcoted, Specify Dia., 5.63 Max 7/8" Key	137.000.106.TC
4	Motor chart, JM140/180	See Chart
	Motor chart, JM210	See Chart
14*	Shaft sleeve, Bronze	110.000.178
	Shaft sleeve, Stainless	110.000.192
26*	Impeller retaining assembly, Stainless	118.000.111A
32*	Key, Stainless	102.000.102
38*	O-ring, Shaft, Buna	116.000.117
	O-ring, Shaft, Viton	116.000.105
40*	Flinger, Stainless	104.000.165
71	Adapter, Iron, JM140/180 1-1/2" Seal, Brass plug	132.000.194X
	Adapter, Iron, JM210 1-1/2" Seal, Brass plug	132.000.195X
73*	Gasket, Case, Buna	116.000.146
89*	Seal, 1-1/2", Type 21, BN-CARB/CM	101.000.168
	Seal, 1-1/2", Type 21, EPDM-CARB/SIL	101.000.175B
	Seal, 1-1/2", Type 21, EPDM-SIL/SIL	101.000.204A
	Seal, 1-1/2", Type 21, VN-CARB/CM	101.000.191
	Seal, 1-1/2", Type 21, VN-CARB/SIL	101.000.175
	Seal, 1-1/2", Type 21, VN-SIL/SIL	101.000.204
89A*	Seal spring retainer, Stainless	104.000.175
KIT	Repair Kit, 1-1/2" BN-CARB/CM Seal, Brz sleeve, BN O-ring	118.000.343
	Repair Kit, 1-1/2" EPDM-CARB/SIL Seal, Brz sleeve, BN O-ring	118.000.343D
	Repair Kit, 1-1/2" EPDM-SIL/SIL Seal, Brz sleeve, BN O-ring	118.000.343J
	Repair Kit, 1-1/2" VN-CARB/CM Seal, Brz sleeve, BN O-ring	118.000.343M
	Repair Kit, 1-1/2" VN-CARB/CM Seal, Stn sleeve, VN O-ring	118.000.343A
	Repair Kit, 1-1/2" VN-CARB/SIL Seal, Brz sleeve, BN O-ring	118.000.343B
	Repair Kit, 1-1/2" VN-SIL/SIL Seal, Stn sleeve, VN O-ring	118.000.343F

* Denotes components included in repair kit.

Motor Charts

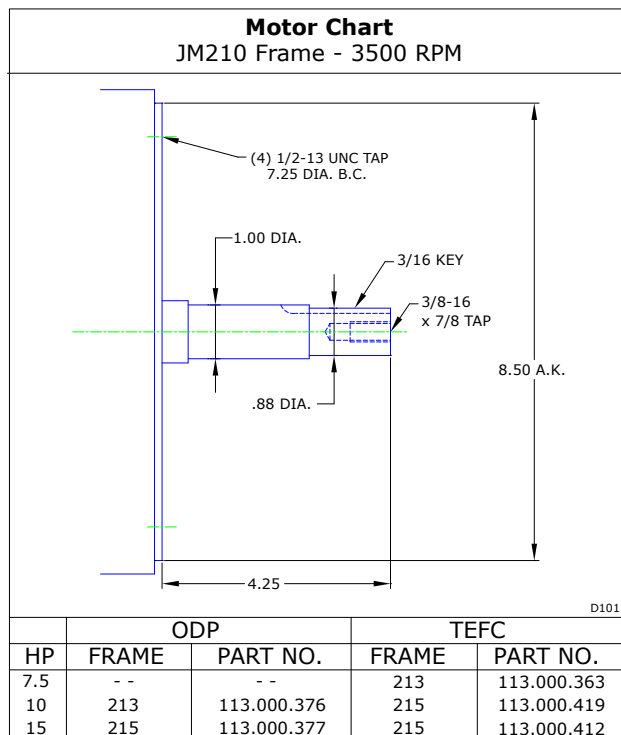
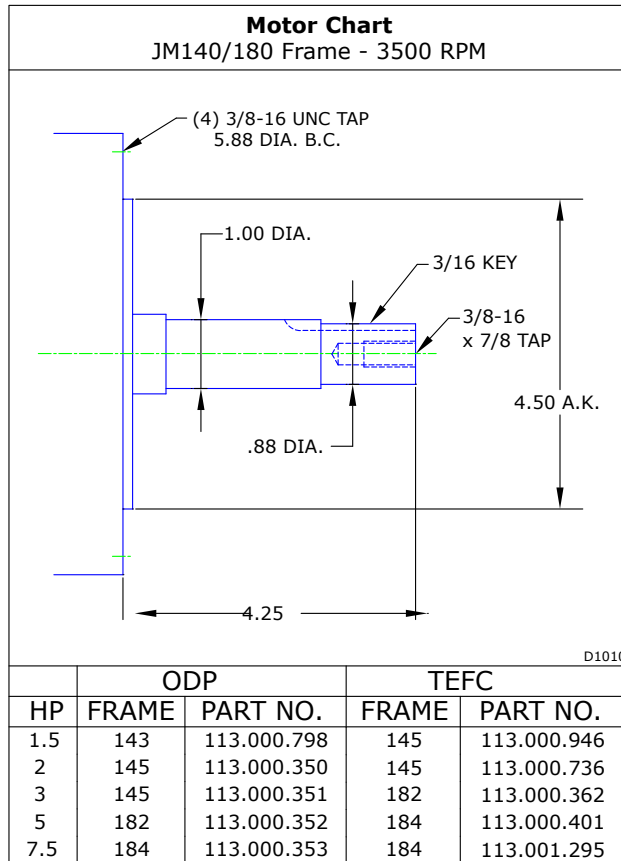

Construction Options

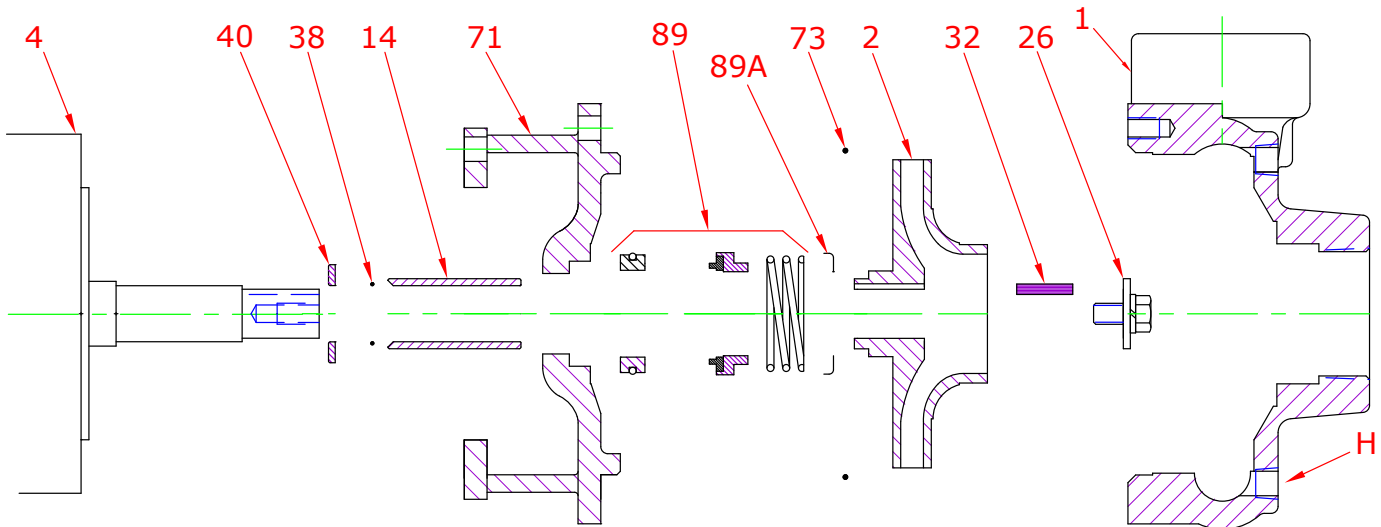

Construction Options			
Key	Part Name	Standard Fitted	All Iron
1	Case	Iron	Iron
2	Impeller	Iron, Tefcoted	Iron, Tefcoted
14	Shaft Sleeve	Bronze	Stainless
26	Impeller Retaining Assembly	Stainless	Stainless
32	Key	Stainless	Stainless
38	O-Ring, Shaft	Buna	Buna
40	Flinger	Stainless	Stainless
71	Adapter	Iron	Iron
73	Gasket, Case	Buna	Buna
89	Mechanical Seal, Type 21 BN-CM	Standard	Standard
89A	Seal Retainer	Stainless	Stainless
H	Plug, Drain	Brass	Plated Steel