



A WILO BRAND

# MOTORPUMP™ — 1750 RPM

Bronze, 60 Hz, 2.5 X 2.5 X 5.63 NPT

# 122 C56

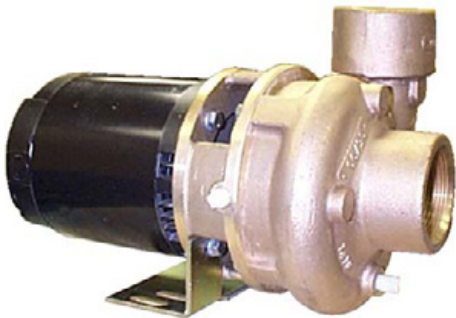

MOTOR DIMENSIONS NEMA C56 FRAME 1750 RPM							
HP	FRAME	ODP			TEFC		
		L	O	AB	L	O	AB
0.5	C56	9.16	6.19	5.06	9.48	7.25	5.88
0.75	C56	9.78	6.19	5.06	9.87	7.25	5.88

DRAWING DEPICTS 56C ODP MOTOR  
ALL DIMENSIONS IN INCHES

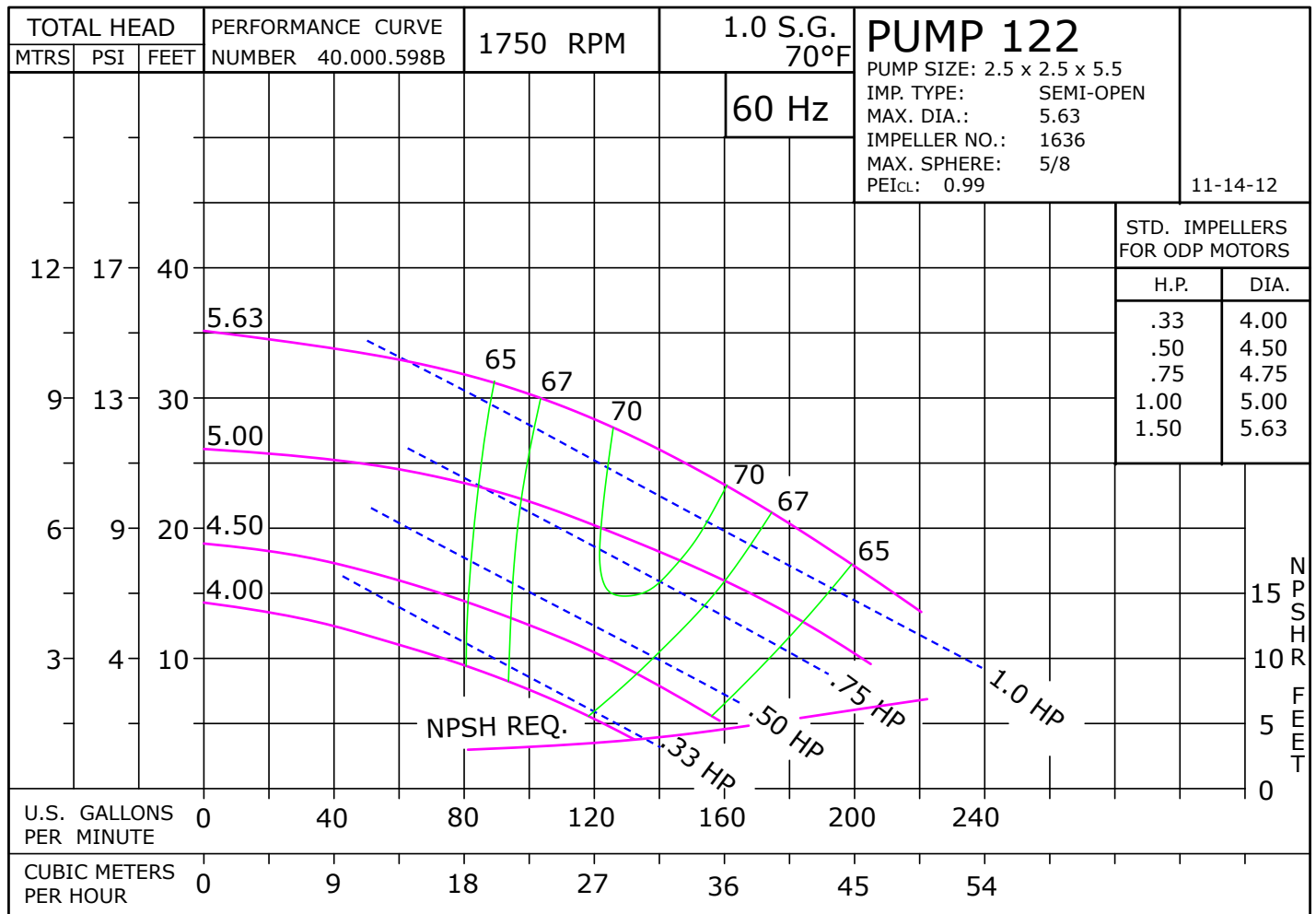
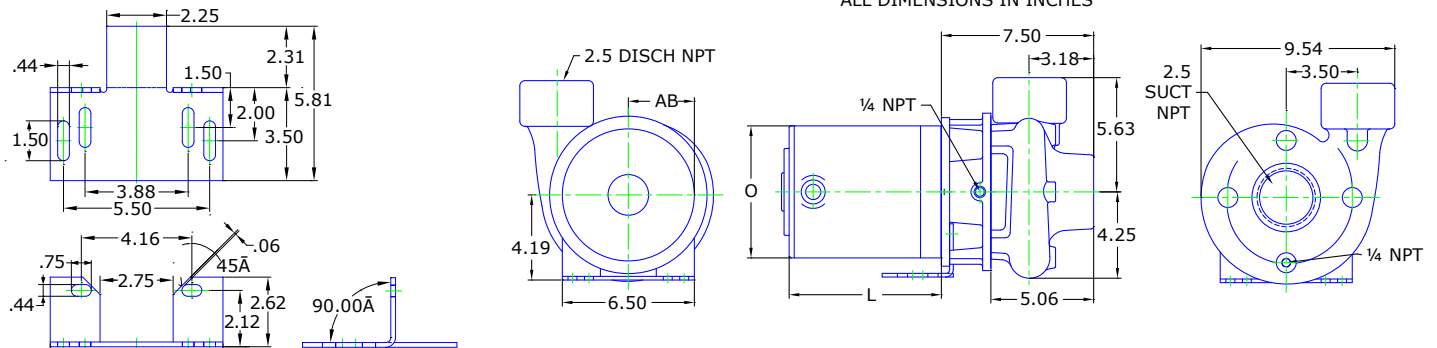

## Parts

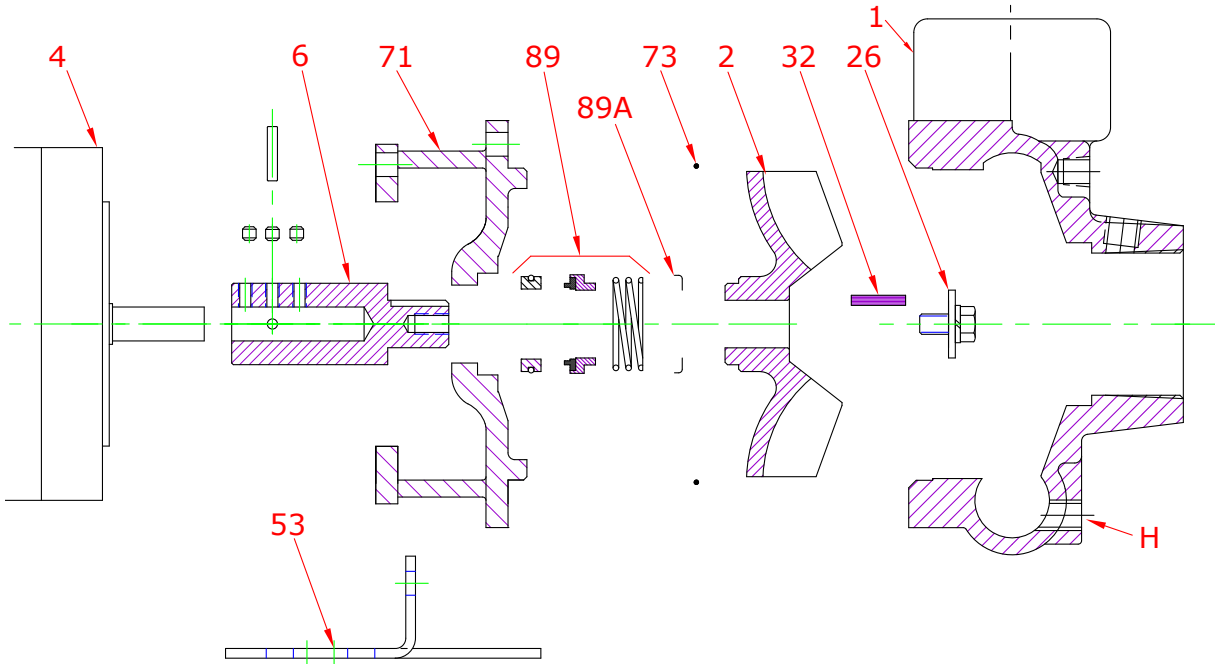

Key No.	Part Name	Part Number
1	Case 121/122, Bronze, 2.50 X 2.50 NPT Brass plug	130.000.274X
2	Impeller 25/122, Bronze, Specify Dia., 5.62 Max 7/8" Key	131.000.807
4	Motor chart, C56	See Chart
6*	Stub Shaft Ass'y Stainless, includes set screws and pin	135.000.174X
	Stub Shaft Ass'y, Brass, includes set screws and pin	135.000.165X
26*	Impeller retaining assembly, Stainless	118.000.111A
32*	Key, Stainless	102.000.102
53	Base, Steel	119.000.237A
71	Adapter, Bronze, JM140/180 1-1/2" Seal, with Brass plug	132.000.219X
73*	Gasket, Case, Buna	116.000.146
89*	Seal, 1-1/2", Type 21, BN-CARB/CM	101.000.168
	Seal, 1-1/2", Type 21, EPDM-CARB/SIL	101.000.175B
	Seal, 1-1/2", Type 21, EPDM-SIL/SIL	101.000.204A
	Seal, 1-1/2", Type 21, VN-CARB/CM	101.000.191
	Seal, 1-1/2", Type 21, VN-CARB/SIL	101.000.175
	Seal, 1-1/2", Type 21, VN-SIL/SIL	101.000.204
89A*	Seal spring retainer, Stainless	104.000.202
KIT	Repair Kit, 1-1/2" BN-CARB/CM Seal, Brz stub	118.000.621
	Repair Kit, 1-1/2" EPDM-CARB/SIL Seal, Brz stub	118.000.621C
	Repair Kit, 1-1/2" EPDM-SIL/SIL Seal, Brz stub	118.000.621E
	Repair Kit, 1-1/2" VN-CARB/CM Seal, Stn stub	118.000.621A
	Repair Kit, 1-1/2" VN-CARB/SIL Seal, Brz stub	118.000.621B
	Repair Kit, 1-1/2" VN-SIL/SIL Seal, Stn stub	118.000.621D

\* Denotes components included in repair kit.

## Motor Charts

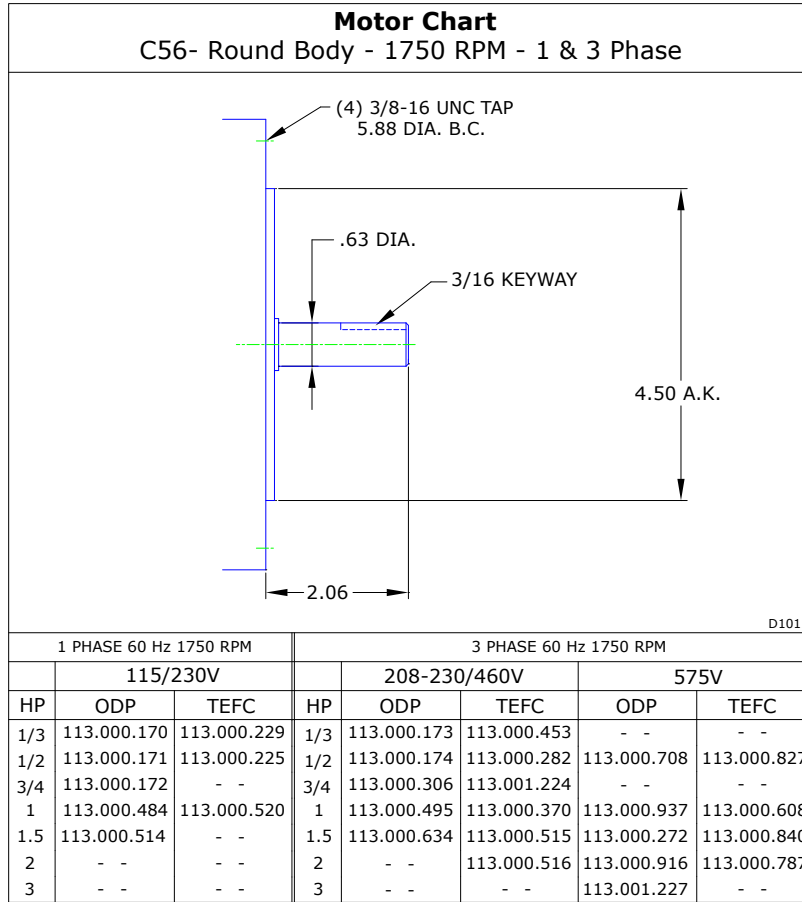

**Construction Options**

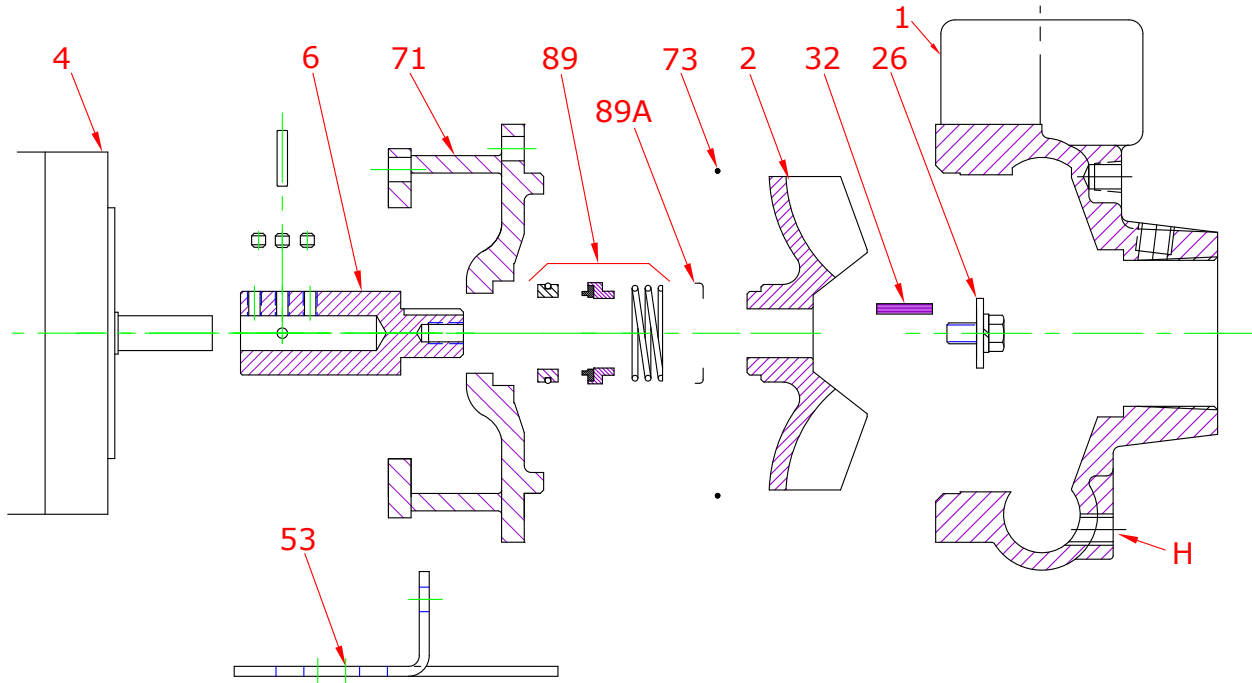

Construction Options		
Key No.	Part Name	All Bronze
1	Case	Bronze
2	Impeller	Bronze
6	Shaft Stub	Bronze
26	Impeller Retaining Assembly	Stainless
32	Key	Stainless
53	Base	Steel
71	Adapter	Bronze
73	Gasket, Case	Buna
89	Mechanical Seal, Type 21, BN-CARB/CM	Standard
89A	Seal Spring Retainer	Stainless
H	Plug, Drain	Brass