

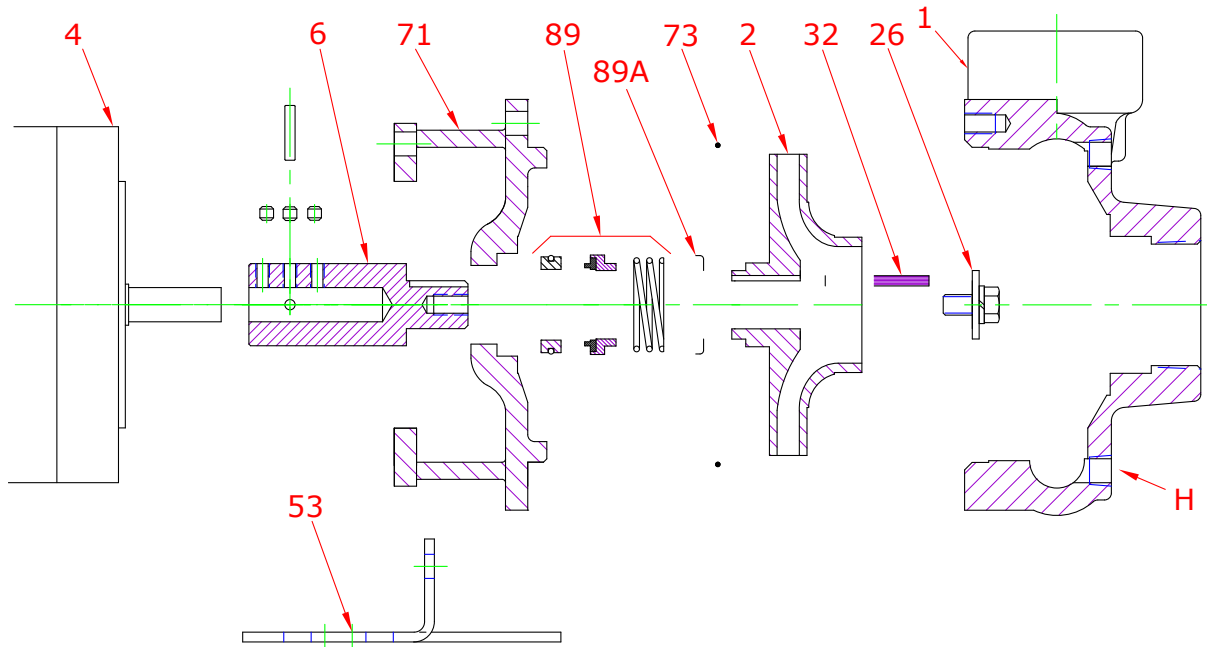

## Parts



| Key No. | Part Name   | Part Number  |
|---------|---|--------------|
| 1       | Case 17B, Bronze, 2.00 X 2.00 NPT Brass plug            | 189.001.042X |
| 2       | Impeller 17, Bronze, Specify Dia., 5.50 Max 7/8" Key    | 131.000.806  |
| 4       | Motor chart, C56  | See Chart    |
| 6*      | Stub Shaft Ass'y Stainless, includes set screws and pin | 135.000.174X |
|         | Stub Shaft Ass'y, Brass, includes set screws and pin    | 135.000.165X |
| 26*     | Impeller retaining assembly, Stainless                  | 118.000.111A |
| 32*     | Key, Stainless  | 102.000.102  |
| 53      | Base, Steel   | 119.000.237A |
| 71      | Adapter, Bronze, JM140/180 1-1/2" Seal, with Brass plug | 132.000.219X |
| 73*     | Gasket, Case, Buna                                      | 116.000.146  |
| 89*     | Seal, 1-1/2", Type 21, BN-CARB/CM                       | 101.000.168  |
|         | Seal, 1-1/2", Type 21, EPDM-CARB/SIL                    | 101.000.175B |
|         | Seal, 1-1/2", Type 21, EPDM-SIL/SIL                     | 101.000.204A |
|         | Seal, 1-1/2", Type 21, VN-CARB/CM                       | 101.000.191  |
|         | Seal, 1-1/2", Type 21, VN-CARB/SIL                      | 101.000.175  |
|         | Seal, 1-1/2", Type 21, VN-SIL/SIL                       | 101.000.204  |
| 89A*    | Seal spring retainer, Stainless                         | 104.000.175  |
| KIT     | Repair Kit, 1-1/2" BN-CARB/CM Seal, Brz stub            | 118.000.381  |
|         | Repair Kit, 1-1/2" EPDM-CARB/SIL Seal, Brz stub         | 118.000.381C |
|         | Repair Kit, 1-1/2" EPDM-SIL/SIL Seal, Brz stub          | 118.000.381E |
|         | Repair Kit, 1-1/2" VN-CARB/CM Seal, Stn stub            | 118.000.381A |
|         | Repair Kit, 1-1/2" VN-CARB/SIL Seal, Brz stub           | 118.000.381B |
|         | Repair Kit, 1-1/2" VN-SIL/SIL Seal, Stn stub            | 118.000.381D |

\* Denotes components included in repair kit.

## Motor Charts

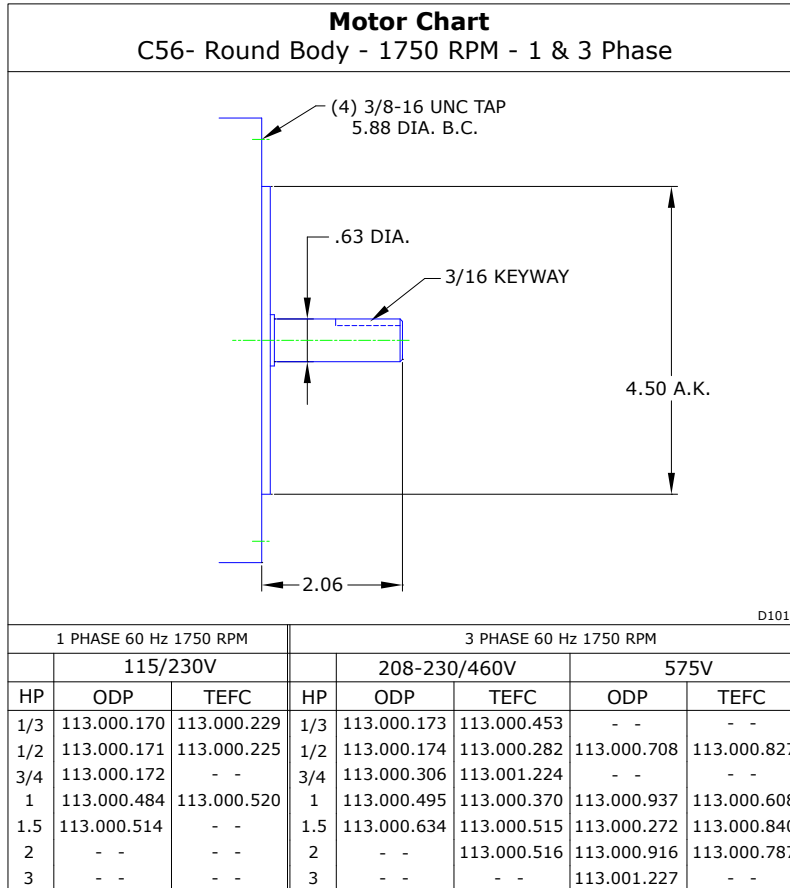

**Construction Options**

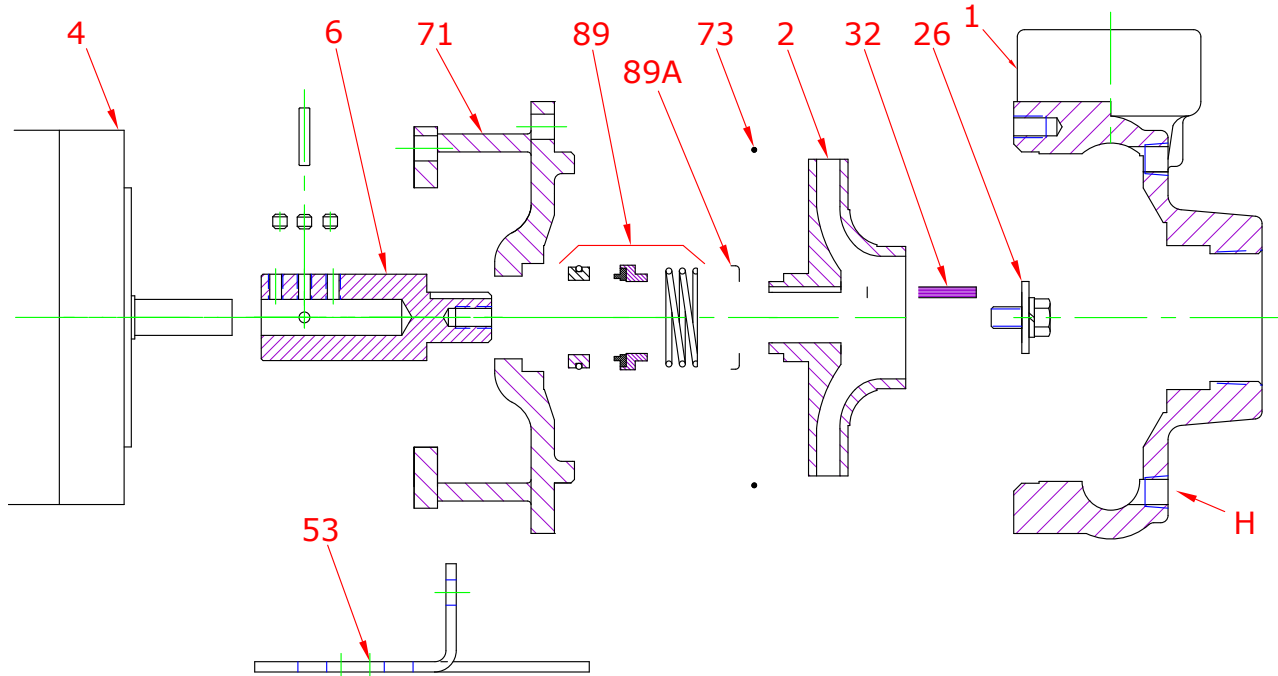

| Construction Options |                                      |            |
|----------------------|--------------------------------------|------------|
| Key No.              | Part Name                            | All Bronze |
| 1                    | Case                                 | Bronze     |
| 2                    | Impeller                             | Bronze     |
| 6                    | Shaft Stub                           | Bronze     |
| 26                   | Impeller Retaining Assembly          | Stainless  |
| 32                   | Key                                  | Stainless  |
| 53                   | Base                                 | Steel      |
| 71                   | Adapter                              | Bronze     |
| 73                   | Gasket, Case                         | Buna       |
| 89                   | Mechanical Seal, Type 21, BN-CARB/CM | Standard   |
| 89A                  | Seal Spring Retainer                 | Stainless  |
| H                    | Plug, Drain                          | Brass      |