

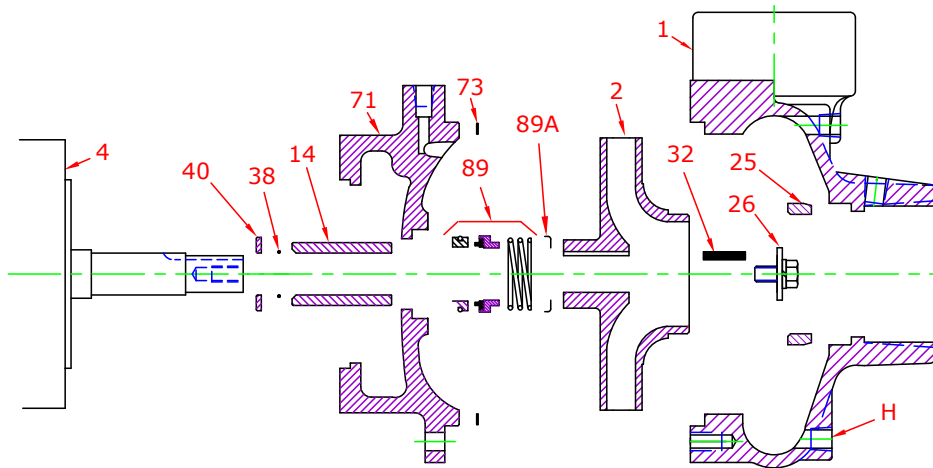

## Parts



| Key No. | Part Name  | Part Number  |
|---------|--|--------------|
| 1+      | Case 55/56, Iron, 3 X 3 NPT Bronze Wear Ring & plugs         | 130.000.243X |
| 2       | Impeller 55, Bronze, Specify Dia., 6.50 Max 7/8" Key         | 137.000.116  |
|         | Impeller 55, Iron, Specify Dia., 6.50 Max 7/8" Key           | 137.000.115  |
| 4       | Motor chart, JM140/180                                       | See Chart    |
| 14*     | Shaft sleeve, Bronze   | 110.000.178  |
|         | Shaft sleeve, Stainless                                      | 110.000.192  |
| 25      | Wear ring, Bronze  | 103.000.138  |
|         | Wear ring, Steel   | 103.000.152  |
| 26*     | Impeller retaining assembly, Stainless                       | 118.000.163A |
| 32*     | Key, Stainless   | 102.000.102  |
| 38*     | O-ring, Shaft, Buna  | 116.000.117  |
|         | O-ring, Shaft, Viton   | 116.000.105  |
| 40*     | Flinger, Stainless   | 104.000.165  |
| 71      | Adapter, Iron, JM140/180 1-1/2" Seal, with Brass plug        | 132.000.202X |
| 73*     | Gasket, Case, Fiber  | 116.000.157  |
| 89*     | Seal, 1-1/2", Type 21, BN-CARB/CM                            | 101.000.168  |
|         | Seal, 1-1/2", Type 21, EPDM-CARB/SIL                         | 101.000.175B |
|         | Seal, 1-1/2", Type 21, EPDM-SIL/SIL                          | 101.000.204A |
|         | Seal, 1-1/2", Type 21, VN-CARB/CM                            | 101.000.191  |
|         | Seal, 1-1/2", Type 21, VN-CARB/SIL                           | 101.000.175  |
|         | Seal, 1-1/2", Type 21, VN-SIL/SIL                            | 101.000.204  |
| 89A*    | Seal spring retainer, Stainless                              | 104.000.174  |
| KIT     | Repair Kit, 1-1/2" BN-CARB/CM Seal, Brz sleeve, BN O-ring    | 118.000.344  |
|         | Repair Kit, 1-1/2" EPDM-CARB/SIL Seal, Brz sleeve, BN O-ring | 118.000.344C |
|         | Repair Kit, 1-1/2" EPDM-SIL/SIL Seal, Brz sleeve, BN O-ring  | 118.000.344D |
|         | Repair Kit, 1-1/2" VN-CARB/CM Seal, Brz sleeve, BN O-ring    | 118.000.344K |
|         | Repair Kit, 1-1/2" VN-CARB/CM Seal, Stn sleeve, VN O-ring    | 118.000.344A |
|         | Repair Kit, 1-1/2" VN-CARB/SIL Seal, Brz sleeve, BN O-ring   | 118.000.344B |
|         | Repair Kit, 1-1/2" VN-SIL/SIL Seal, Stn sleeve, VN O-ring    | 118.000.344F |

\* Denotes components included in repair kit.

+ Includes bronze wear ring. For steel, replace suffix "X" with "X1".

**Motor Charts**

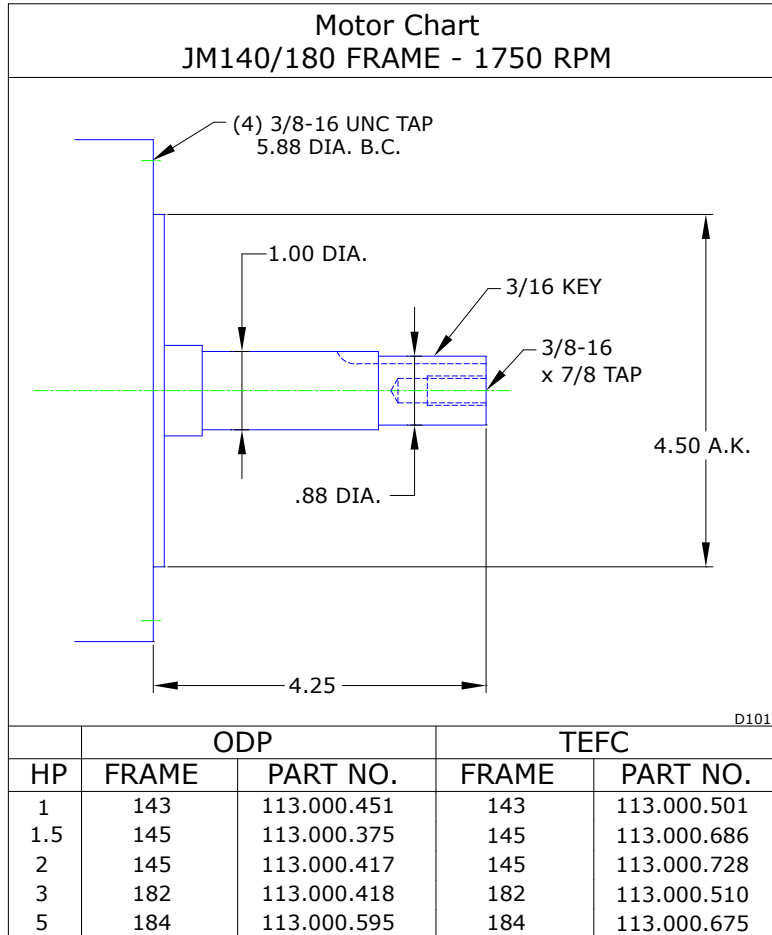

**Construction Options**

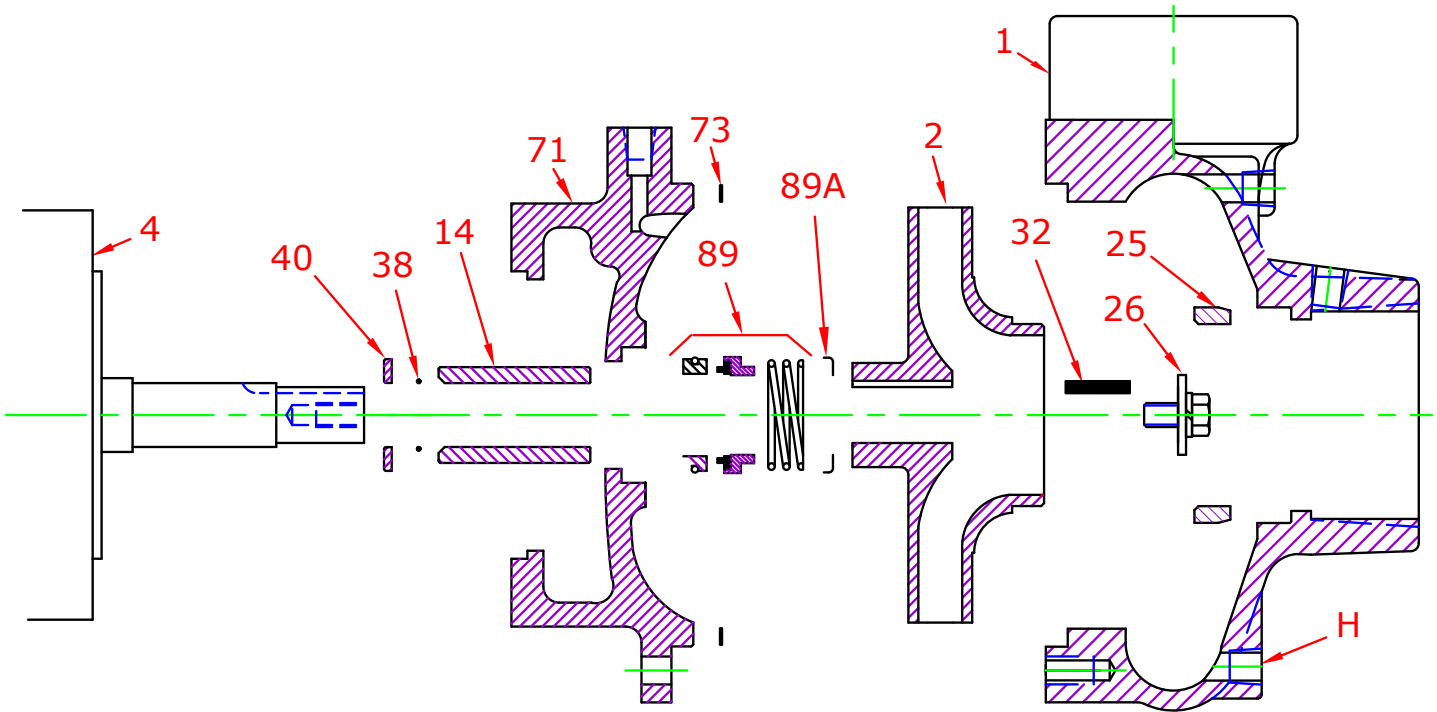

| Construction Options |                                |                 |               |              |
|----------------------|--------------------------------|-----------------|---------------|--------------|
| Key                  | Part Name                      | Standard Fitted | Bronze Fitted | All Iron     |
| 1                    | Case                           | Iron            | Iron          | Iron         |
| 2                    | Impeller                       | Iron            | Bronze        | Iron         |
| 14                   | Shaft Sleeve                   | Bronze          | Bronze        | Stainless    |
| 25                   | Wear Ring                      | Bronze          | Bronze        | Steel        |
| 26                   | Impeller Retaining Assembly    | Stainless       | Stainless     | Stainless    |
| 32                   | Key                            | Stainless       | Stainless     | Stainless    |
| 38                   | O-Ring, Shaft                  | Buna            | Buna          | Buna         |
| 40                   | Flinger                        | Stainless       | Stainless     | Stainless    |
| 71                   | Adapter                        | Iron            | Iron          | Iron         |
| 73                   | Gasket, Case                   | Fiber           | Fiber         | Fiber        |
| 89                   | Mechanical Seal, Type 21 BN-CM | Standard        | Standard      | Standard     |
| 89A                  | Seal Retainer                  | Stainless       | Stainless     | Stainless    |
| H                    | Plug, Drain                    | Brass           | Brass         | Plated Steel |