

Submittal Data Sheet

Wilo-ICL Inline Centrifugal Pumps



ICL 8" 125#



Project:	
Engineer:	
Contractor:	
Submitted By:	Date:
Approved By:	Date:

Tag #	Model #	Flow	Head	HP	Cycle	Phase	Voltage	RPM
					60 HZ	3	460	1750

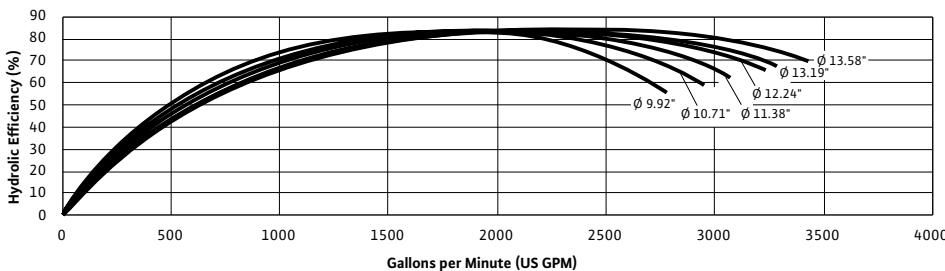
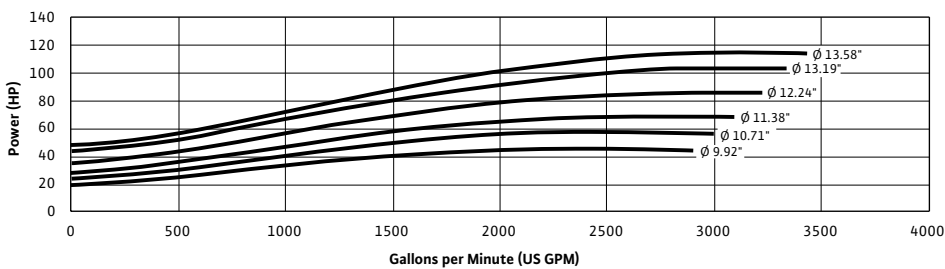
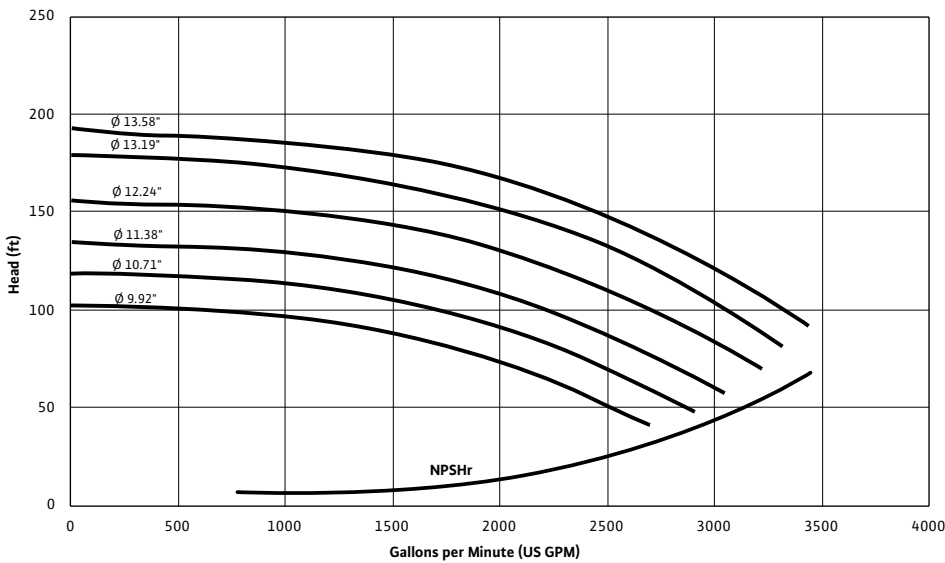

Technical Data

PEI	0.97
Temp Range:	-4 °F to 284 °F [-20 °C to +140 °C]
Power Supply	460 volt
Motor Options	TEFC, EPACT Rated
Max operating pressure:	175 psi [12 bar]

Materials of Construction

Pump volute	CAST IRON GRADE 30 PER ASTM A48
Impeller	Bronze CC480K-GS
Shaft	Stainless Steel AISI 420
Balanced Mechanical seal	Silicon Carbide, Silicon Carbide, EPDM or Viton

Applications

• Hot Water Heating Systems	• Industrial Circulation Systems
• Air Conditioning	• Solar Systems
• Closed Cooling Systems	• Geothermal Systems

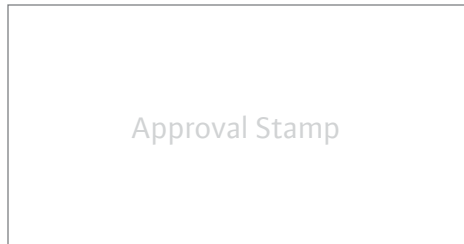

Submittal Data Sheet

Wilo-ICL Inline Centrifugal Pumps



ICL 8" 125# Dimensions & Weights

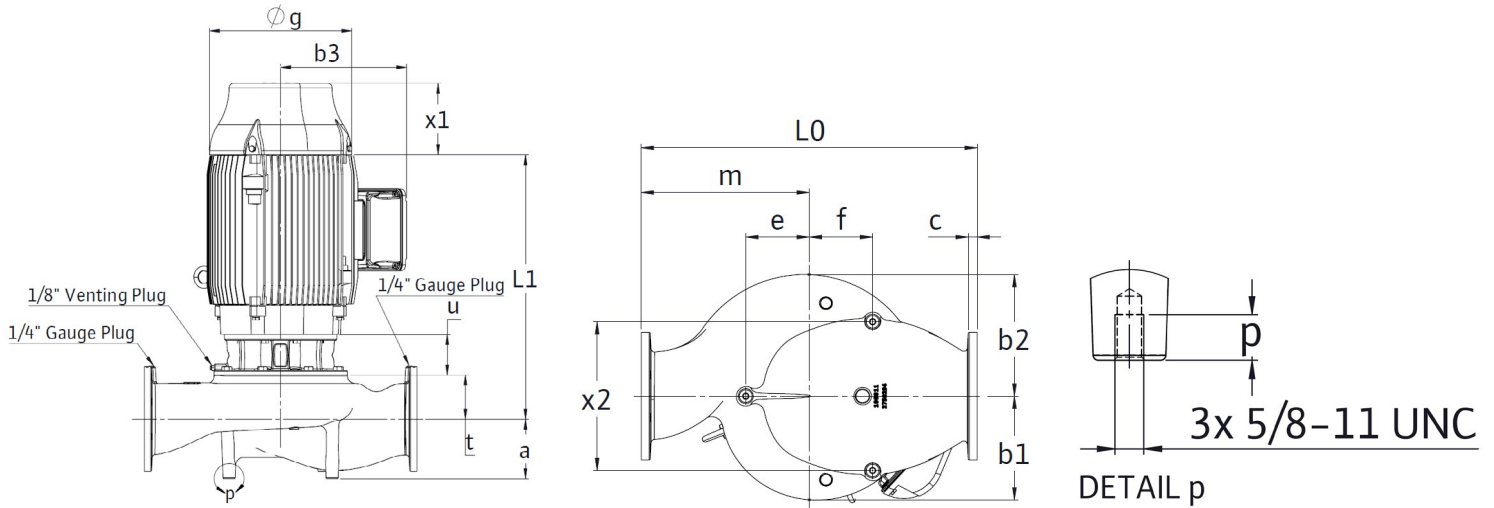

Dimensions and Weights

Dimensions- Inches (mm)

Model	Dia.	L0	a	b ₁	b ₂	b ₃	c	e	f	Øg	L1	m	p	t	u	x1	x2	Weight
ICL 8X8X13.58-TEFC-4-40-326TCZ-460-CI	8	35 ⁷ / ₁₆	7 ¹¹ / ₁₆	11	12 ⁷ / ₈	12 ⁷ / ₁₆	1 ⁵ / ₁₆	6 ¹¹ / ₁₆	6 ¹¹ / ₁₆	15 ⁷ / ₁₆	29 ¹¹ / ₁₆	17 ¹¹ / ₁₆	1	5 ¹¹ / ₁₆	5 ³ / ₄	7 ¹ / ₈	15 ³ / ₄	1150 lbs
	8	(900)	(195)	(279)	(327)	(316)	(24)	(170)	(170)	(392)	(753)	(450)	(25)	(145)	(133)	(181)	(400)	522 kg
ICL 8X8X13.58-TEFC-4-50-326TCZ-460-CI	8	35 ⁷ / ₁₆	7 ¹¹ / ₁₆	11	12 ⁷ / ₈	12 ⁷ / ₁₆	1 ⁵ / ₁₆	6 ¹¹ / ₁₆	6 ¹¹ / ₁₆	15 ⁷ / ₁₆	29 ¹¹ / ₁₆	17 ¹¹ / ₁₆	1	5 ¹¹ / ₁₆	5 ³ / ₄	7 ¹ / ₈	15 ³ / ₄	1210 lbs
	8	(900)	(195)	(279)	(327)	(316)	(24)	(170)	(170)	(392)	(753)	(450)	(25)	(145)	(133)	(181)	(400)	549 kg
ICL 8X8X13.58-TEFC-4-60-365TCZ-460-CI	8	35 ⁷ / ₁₆	7 ¹¹ / ₁₆	11	12 ⁷ / ₈	16 ³ / ₈	1 ⁵ / ₁₆	6 ¹¹ / ₁₆	6 ¹¹ / ₁₆	17 ¹ / ₂	31 ⁹ / ₁₆	17 ¹¹ / ₁₆	1	5 ¹¹ / ₁₆	5 ³ / ₄	8	15 ³ / ₄	1510 lbs
	8	(900)	(195)	(279)	(327)	(416)	(24)	(170)	(170)	(444)	(802)	(450)	(25)	(145)	(133)	(202)	(400)	685 kg
ICL 8X8X13.58-TEFC-4-75-365TCZ-460-CI	8	35 ⁷ / ₁₆	7 ¹¹ / ₁₆	11	12 ⁷ / ₈	16 ³ / ₈	1 ⁵ / ₁₆	6 ¹¹ / ₁₆	6 ¹¹ / ₁₆	17 ¹ / ₂	31 ⁹ / ₁₆	17 ¹¹ / ₁₆	1	5 ¹¹ / ₁₆	5 ³ / ₄	8	15 ³ / ₄	1530 lbs
	8	(900)	(195)	(279)	(327)	(416)	(24)	(170)	(170)	(444)	(802)	(450)	(25)	(145)	(133)	(202)	(400)	694 kg
ICL 8X8X13.58-TEFC-4-100-405TCZ-460-CI	8	35 ⁷ / ₁₆	7 ¹¹ / ₁₆	11	12 ⁷ / ₈	16 ³ / ₈	1 ⁵ / ₁₆	6 ¹¹ / ₁₆	6 ¹¹ / ₁₆	18 ¹ / ₂	34 ³ / ₁₆	17 ¹¹ / ₁₆	1	5 ¹¹ / ₁₆	5 ³ / ₄	9 ¹ / ₁₆	15 ³ / ₄	1800 lbs
	8	(900)	(195)	(279)	(327)	(416)	(24)	(170)	(170)	(470)	(868)	(450)	(25)	(145)	(133)	(234)	(400)	816 kg

EC Motor Data (Single Motor Operation)

Model	P2 [HP]	Phase [-]	Voltage [V]
ICL 8X8X13.58-TEFC-4-40-326TCZ-460-CI	40	3	460
ICL 8X8X13.58-TEFC-4-50-326TCZ-460-CI	50	3	460
ICL 8X8X13.58-TEFC-4-60-365TCZ-460-CI	60	3	460
ICL 8X8X13.58-TEFC-4-75-365TCZ-460-CI	75	3	460
ICL 8X8X13.58-TEFC-4-100-405TCZ-460-CI	100	3	460

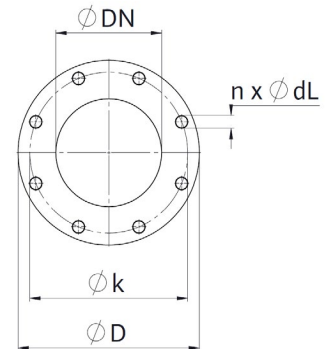

Flange Dimensions

Dimensions- Inches (mm)

DN	ØD	Øk	n x ØdL
8	13 ¹ / ₂ (343)	11 ³ / ₄ (298)	8 x Ø ⁷ / ₈ 8 x (22)

Wilo USA

T +1 262 204 6600
F +1 888 945 6873
www.wilo-usa.com
info.us@wilo.com

Wilo Canada Inc.

T +1 866 945 6236
F +1 403 277 9456
www.wilo-canada.com
info@wilo-canada.com

Wilo Mexico

T +52 55 5586 3209
F +52 1 55 5413 4165
www.wilo-mexico.com.mx
info@wilo.com.mx

Submittal Data Sheet

Wilo-ICL Inline Centrifugal Pumps



ICL 8" 250#



Project:	
Engineer:	
Contractor:	
Submitted By:	Date:
Approved By:	Date:

Tag #	Model #	Flow	Head	HP	Cycle	Phase	Voltage	RPM
					60 HZ	3	460	1750

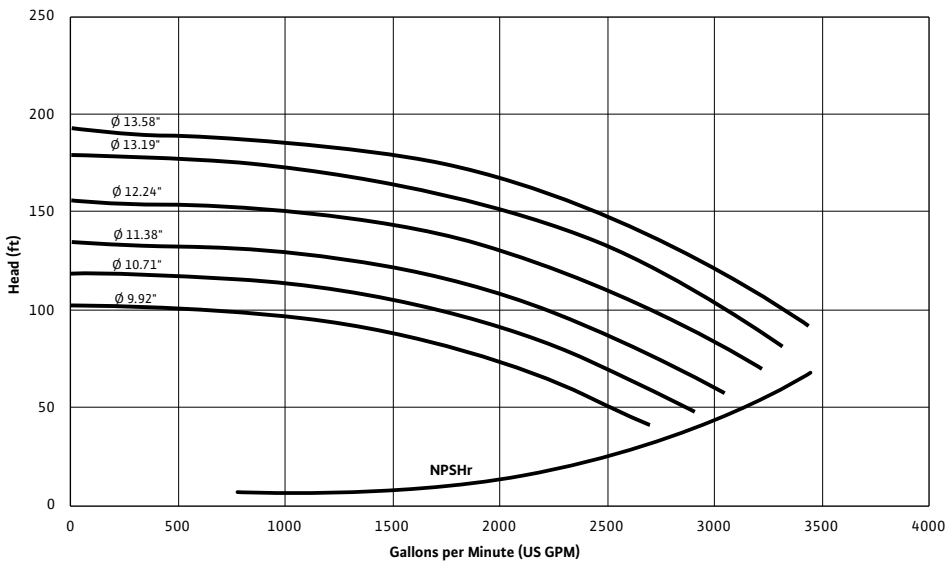

Technical Data

PEI	0.97
Temp Range:	-4 °F to 284 °F [-20 °C to +140 °C]
Power Supply	460 volt
Motor Options	TEFC, EPACT Rated
Max operating pressure:	363 psi [25 bar]

Materials of Construction

Pump volute	DUCTILE IRON GRADE 65-45-12 PER ASTM A536
Impeller	Bronze CC480K-GS
Shaft	Stainless Steel AISI 420
Balanced Mechanical seal	Silicon Carbide, Silicon Carbide, Viton

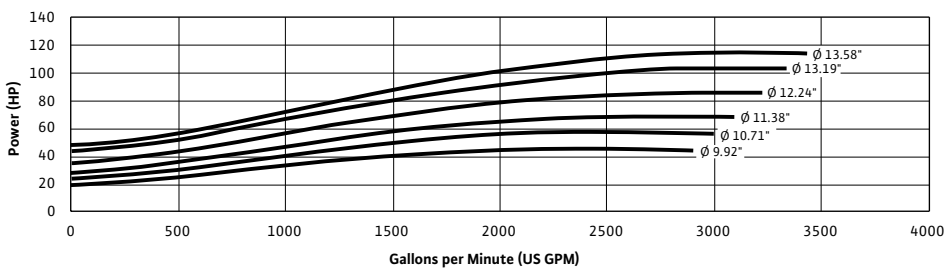

Applications

• Hot Water Heating Systems	• Industrial Circulation Systems
• Air Conditioning	• Solar Systems
• Closed Cooling Systems	• Geothermal Systems

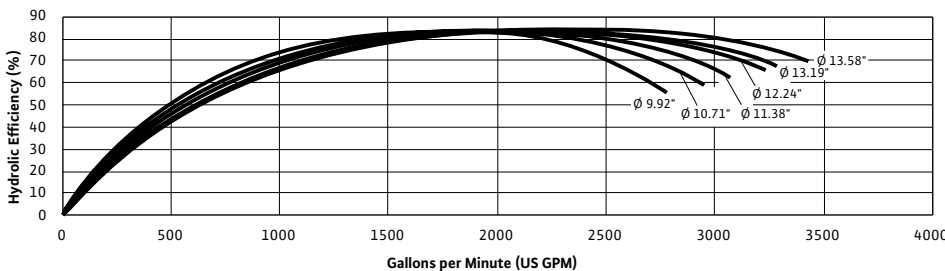

Approval Stamp

Submittal Data Sheet

Wilco-ICL Inline Centrifugal Pumps



ICL 8" 250# Dimensions & Weights

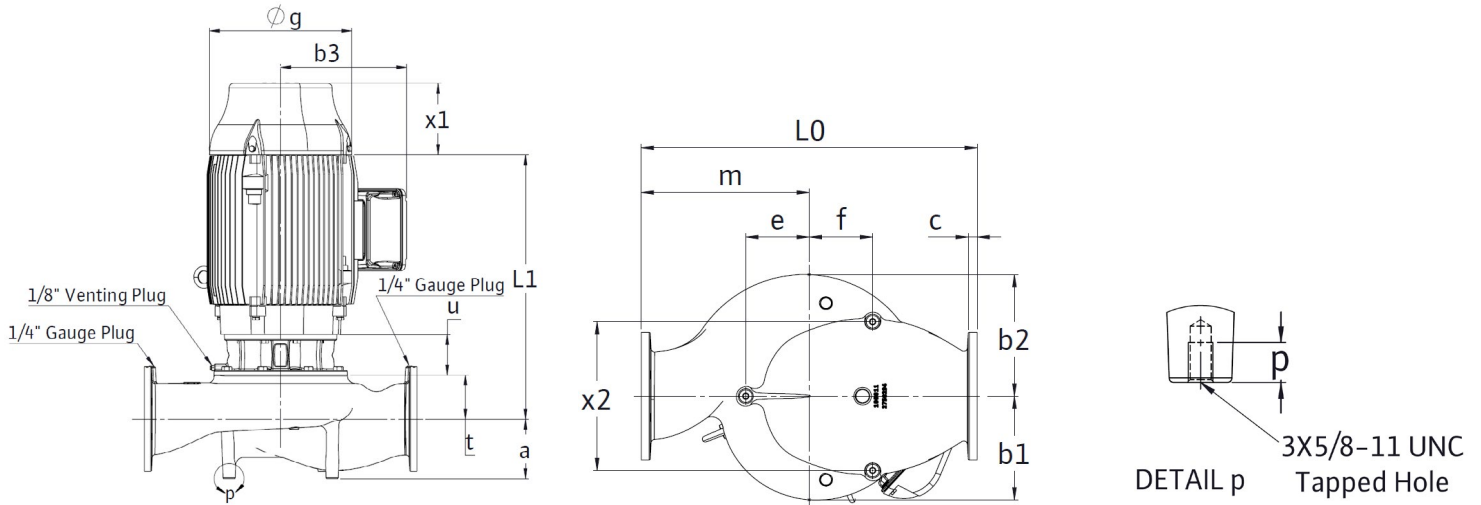

Dimensions and Weights

Dimensions- Inches (mm)

Model	Dia.	L0	a	b ₁	b ₂	b ₃	c	e	f	Øg	L1	m	p	t	u	x1	x2	Weight
ICL 8X8X13.58-TEFC-4-40-326TCZ-460-DI	8	35 ⁷ / ₁₆	7 ¹¹ / ₁₆	11	12 ⁷ / ₈	12 ⁷ / ₁₆	1 ⁵ / ₈	6 ¹¹ / ₁₆	6 ¹¹ / ₁₆	15 ⁷ / ₁₆	29 ¹¹ / ₁₆	17 ¹¹ / ₁₆	1	5 ¹¹ / ₁₆	5 ³ / ₄	7 ¹ / ₈	15 ³ / ₄	1190 lbs
		(900)	(195)	(279)	(327)	(316)	(41)	(170)	(170)	(392)	(753)	(450)	(25)	(145)	(133)	(181)	(400)	540 kg
ICL 8X8X13.58-TEFC-4-50-326TCZ-460-DI	8	35 ⁷ / ₁₆	7 ¹¹ / ₁₆	11	12 ⁷ / ₈	12 ⁷ / ₁₆	1 ⁵ / ₈	6 ¹¹ / ₁₆	6 ¹¹ / ₁₆	15 ⁷ / ₁₆	29 ¹¹ / ₁₆	17 ¹¹ / ₁₆	1	5 ¹¹ / ₁₆	5 ³ / ₄	7 ¹ / ₈	15 ³ / ₄	1250 lbs
		(900)	(195)	(279)	(327)	(316)	(41)	(170)	(170)	(392)	(753)	(450)	(25)	(145)	(133)	(181)	(400)	567 kg
ICL 8X8X13.58-TEFC-4-60-365TCZ-460-DI	8	35 ⁷ / ₁₆	7 ¹¹ / ₁₆	11	12 ⁷ / ₈	16 ³ / ₈	1 ⁵ / ₈	6 ¹¹ / ₁₆	6 ¹¹ / ₁₆	17 ¹ / ₂	31 ⁹ / ₁₆	17 ¹¹ / ₁₆	1	5 ¹¹ / ₁₆	5 ³ / ₄	8	15 ³ / ₄	1550 lbs
		(900)	(195)	(279)	(327)	(416)	(41)	(170)	(170)	(444)	(802)	(450)	(25)	(145)	(133)	(202)	(400)	703 kg
ICL 8X8X13.58-TEFC-4-75-365TCZ-460-DI	8	35 ⁷ / ₁₆	7 ¹¹ / ₁₆	11	12 ⁷ / ₈	16 ³ / ₈	1 ⁵ / ₈	6 ¹¹ / ₁₆	6 ¹¹ / ₁₆	17 ¹ / ₂	31 ⁹ / ₁₆	17 ¹¹ / ₁₆	1	5 ¹¹ / ₁₆	5 ³ / ₄	8	15 ³ / ₄	1570 lbs
		(900)	(195)	(279)	(327)	(416)	(41)	(170)	(170)	(444)	(802)	(450)	(25)	(145)	(133)	(202)	(400)	712 kg
ICL 8X8X13.58-TEFC-4-100-405TCZ-460-DI	8	35 ⁷ / ₁₆	7 ¹¹ / ₁₆	11	12 ⁷ / ₈	16 ³ / ₈	1 ⁵ / ₈	6 ¹¹ / ₁₆	6 ¹¹ / ₁₆	18 ¹ / ₂	34 ³ / ₁₆	17 ¹¹ / ₁₆	1	5 ¹¹ / ₁₆	5 ³ / ₄	9 ¹ / ₁₆	15 ³ / ₄	1840 lbs
		(900)	(195)	(279)	(327)	(416)	(41)	(170)	(170)	(470)	(868)	(450)	(25)	(145)	(133)	(234)	(400)	835 kg

EC Motor Data (Single Motor Operation)

Model	P2 [HP]	Phase [-]	Voltage [V]
ICL 8X8X13.58-TEFC-4-40-326TCZ-460-DI	40	3	460
ICL 8X8X13.58-TEFC-4-50-326TCZ-460-DI	50	3	460
ICL 8X8X13.58-TEFC-4-60-365TCZ-460-DI	60	3	460
ICL 8X8X13.58-TEFC-4-75-365TCZ-460-DI	75	3	460
ICL 8X8X13.58-TEFC-4-100-405TCZ-460-DI	100	3	460

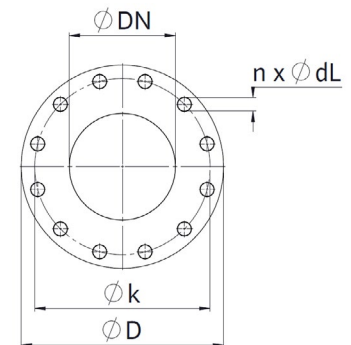

Flange Dimensions

Dimensions- Inches (mm)

DN	ØD	Øk	n x ØdL
8	15 (381)	13 (330)	12 x Ø1 12 x (12)

Wilco USA

T +1 262 204 6600
F +1 888 945 6873
www.wilco-usa.com
info.us@wilco.com

Wilco Canada Inc.

T +1 866 945 6236
F +1 403 277 9456
www.wilco-canada.com
info@wilco-canada.com

Wilco Mexico

T +52 55 5586 3209
F +52 1 55 5413 4165
www.wilco-mexico.com.mx
info@wilco.com.mx