

# Submittal Data Sheet

## Wilo-ICL Inline Centrifugal Pumps



### ICL 4" 125#



Project:	
Engineer:	
Contractor:	
Submitted By:	Date:
Approved By:	Date:

Tag #	Model #	Flow	Head	HP	Cycle	Phase	Voltage	RPM
					60 HZ	3	460	1750

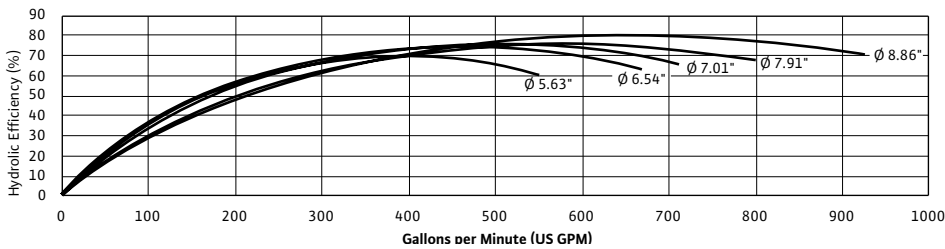
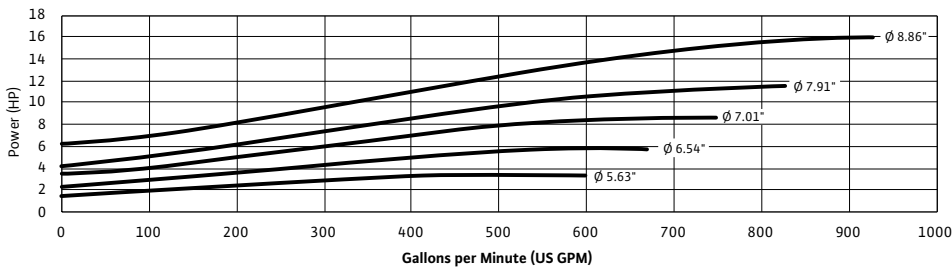
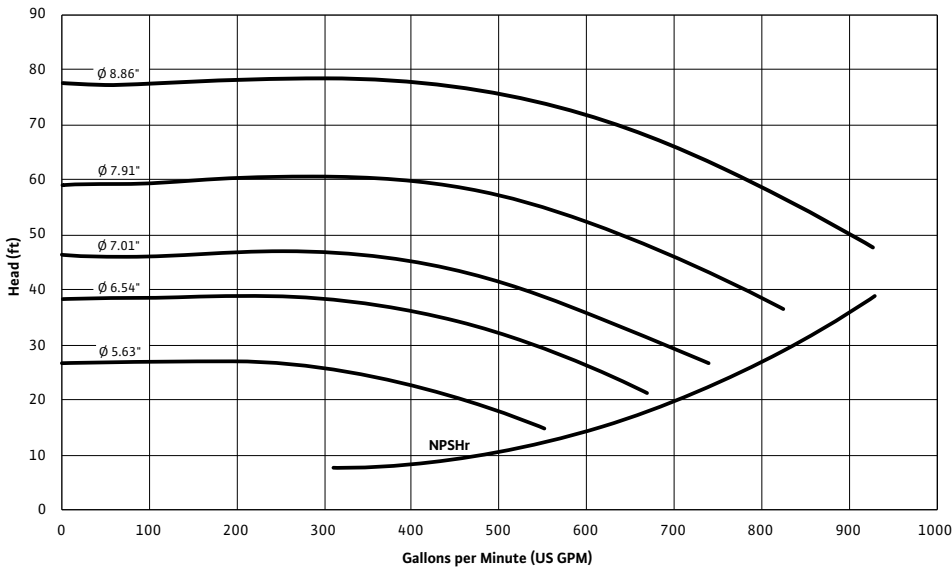

#### Technical Data

PEI	0.99
Temp Range:	-4 °F to 284 °F [-20 °C to +140 °C]
Power Supply	460V
Motor Options	TEFC, EPACT Rated
Max operating pressure:	175 psi [12 bar]

#### Materials of Construction

Pump volute	CAST IRON GRADE 30 PER ASTM A48
Impeller	Bronze CC480K-GS
Shaft	Stainless Steel AISI 420
Balanced Mechanical seal	Silicon Carbide, Silicon Carbide, EPDM or Viton

#### Applications

• Hot Water Heating Systems	• Industrial Circulation Systems
• Air Conditioning	• Solar Systems
• Closed Cooling Systems	• Geothermal Systems

Approval Stamp

# Submittal Data Sheet

## Wilo-ICL Inline Centrifugal Pumps



### ICL 4" 125# Dimensions & Weights

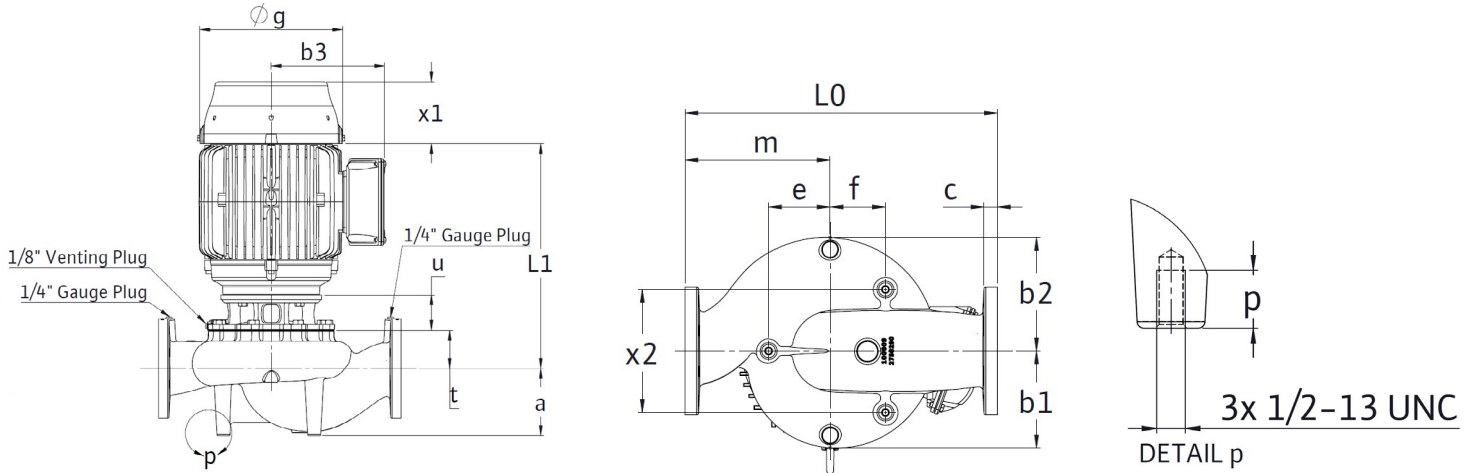

#### Dimensions and Weights

Dimensions- Inches (mm)

Model	Dia.	L0	a	b <sub>1</sub>	b <sub>2</sub>	b <sub>3</sub>	c	e	f	Øg	L1	m	p	t	u	x1	x2	Weight
ICL 4X4X8.86-TEFC-4-3-184TCZ-460-CI	4	22	6 1/8	6 33/16	8	7 1/2	15/16	4 5/16	3 7/8	8 15/16	15 11/16	10 1/4	1	3 7/16	3 3/16	4 1/16	8 11/16	270 lbs
	4	(559)	(155)	(173)	(203)	(191)	(24)	(110)	(99)	(227)	(398)	(260)	(25)	(88)	(81)	(103)	(220)	122 kg
ICL 4X4X8.86-TEFC-4-5-184TCZ-460-CI	4	22	6 1/8	6 33/16	8	7 9/16	15/16	4 5/16	3 7/8	8 15/16	15 11/16	10 1/4	1	3 7/16	3 3/16	4 1/16	8 11/16	290 lbs
	4	(559)	(155)	(173)	(203)	(192)	(24)	(110)	(99)	(227)	(398)	(260)	(25)	(88)	(81)	(103)	(220)	132 kg
ICL 4X4X8.86-TEFC-4-7.5-215TCZ-460-CI	4	22	6 1/8	6 33/16	8	8 5/8	15/16	4 5/16	3 7/8	10 9/16	18 1/4	10 1/4	1	3 7/16	3 3/16	4 9/16	8 11/16	350 lbs
	4	(559)	(155)	(173)	(203)	(219)	(24)	(110)	(99)	(268)	(464)	(260)	(25)	(88)	(81)	(116)	(220)	159 kg
ICL 4X4X8.86-TEFC-4-10-215TCZ-460-CI	4	22	6 1/8	6 33/16	8	8 5/8	15/16	4 5/16	3 7/8	10 9/16	18 1/4	10 1/4	1	3 7/16	3 3/16	4 1/2	8 11/16	360 lbs
	4	(559)	(155)	(173)	(203)	(219)	(24)	(110)	(99)	(268)	(464)	(260)	(25)	(88)	(81)	(115)	(220)	163 kg
ICL 4X4X8.86-TEFC-4-15-254TCZ-460-CI	4	22	6 1/8	6 33/16	8	10 7/16	15/16	4 5/16	3 7/8	12 15/16	20 3/8	10 1/4	1	3 7/16	3 3/16	5 5/8	8 11/16	455 lbs
	4	(559)	(155)	(173)	(203)	(265)	(24)	(110)	(99)	(329)	(518)	(260)	(25)	(88)	(81)	(142)	(220)	206 kg

#### EC Motor Data (Single Motor Operation)

Model	P2	Phase	Voltage
	[HP]	[~]	[V]
ICL 4X4X8.86-TEFC-4-3-184TCZ-460-CI	3	3	460
ICL 4X4X8.86-TEFC-4-5-184TCZ-460-CI	5	3	460
ICL 4X4X8.86-TEFC-4-7.5-215TCZ-460-CI	7.5	3	460
ICL 4X4X8.86-TEFC-4-10-215TCZ-460-CI	10	3	460
ICL 4X4X8.86-TEFC-4-15-254TCZ-460-CI	15	3	460

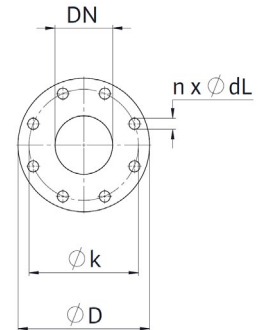

#### Flange Dimensions

Dimensions- Inches (mm)			
DN	ØD	Øk	nx ØdL
4	9 (229)	7 1/2 (191)	8x Ø4 8x (19)

Wilo USA

T +1 262 204 6600  
F +1 888 945 6873  
www.wilo-usa.com  
info.us@wilo.com

Wilo Canada Inc.

T +1 866 945 6236  
F +1 403 277 9456  
www.wilo-canada.com  
info@wilo-canada.com

Wilo Mexico

T +52 55 5586 3209  
F +52 1 55 5413 4165  
www.wilo-mexico.com.mx  
info@wilo.com.mx

# Submittal Data Sheet

## Wilo-ICL Inline Centrifugal Pumps



### ICL 4" 250#



Project:							
Engineer:							
Contractor:							
Submitted By:				Date:			
Approved By:				Date:			

Tag #	Model #	Flow	Head	HP	Cycle	Phase	Voltage	RPM
					60 HZ	3	460	1750

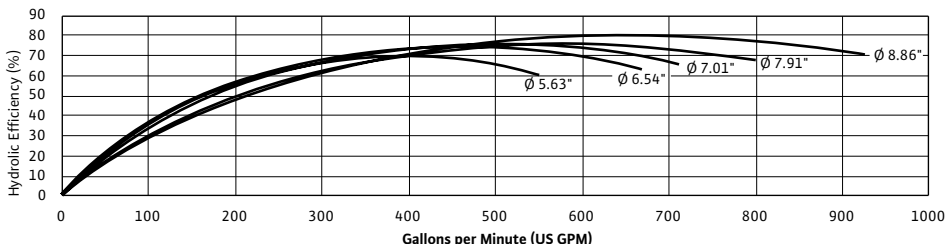
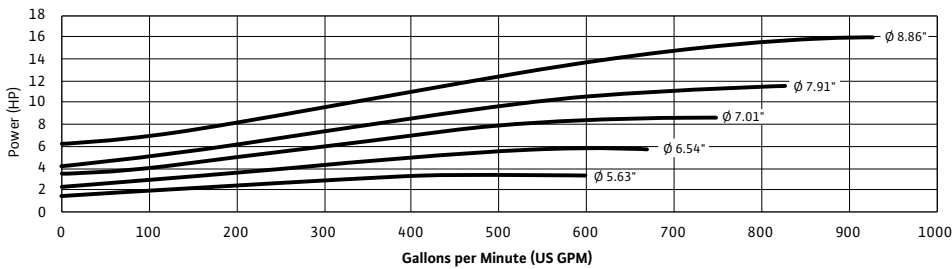
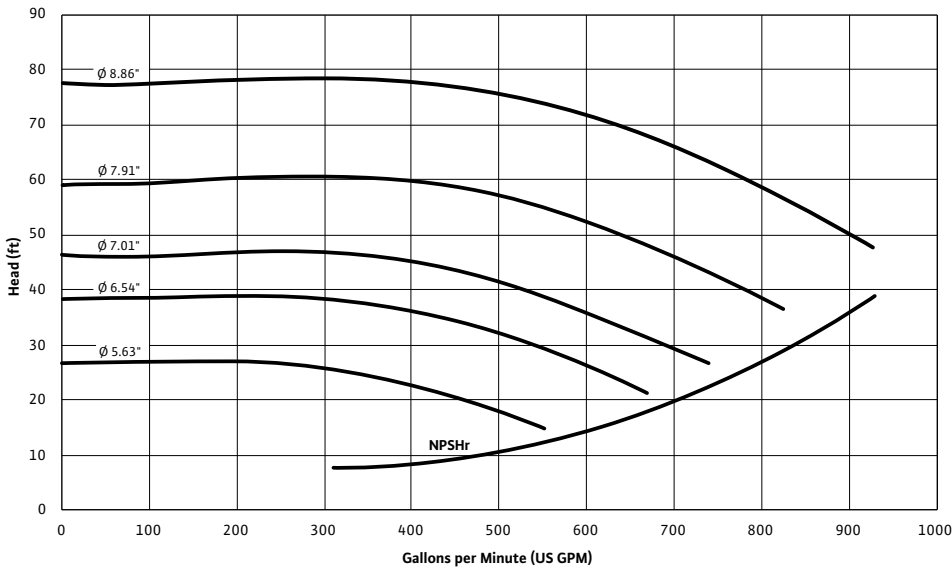

#### Technical Data

PEI	0.99
Temp Range:	-4 °F to 284 °F [-20 °C to +140 °C]
Power Supply	460V
Motor Options	TEFC, EPACK Rated
Max operating pressure:	363 psi [25 bar]

#### Materials of Construction

Pump volute	DUCTILE IRON GRADE 65-45-12 PER ASTM A536
Impeller	Bronze CC480K-GS
Shaft	Stainless Steel AISI 420
Balanced Mechanical seal	Silicon Carbide, Silicon Carbide, Viton

#### Applications

- Hot Water Heating Systems
- Industrial Circulation Systems
- Air Conditioning
- Solar Systems
- Closed Cooling Systems
- Geothermal Systems

Approval Stamp

# Submittal Data Sheet

## Wilo-ICL Inline Centrifugal Pumps



### ICL 4" 250# Dimensions & Weights

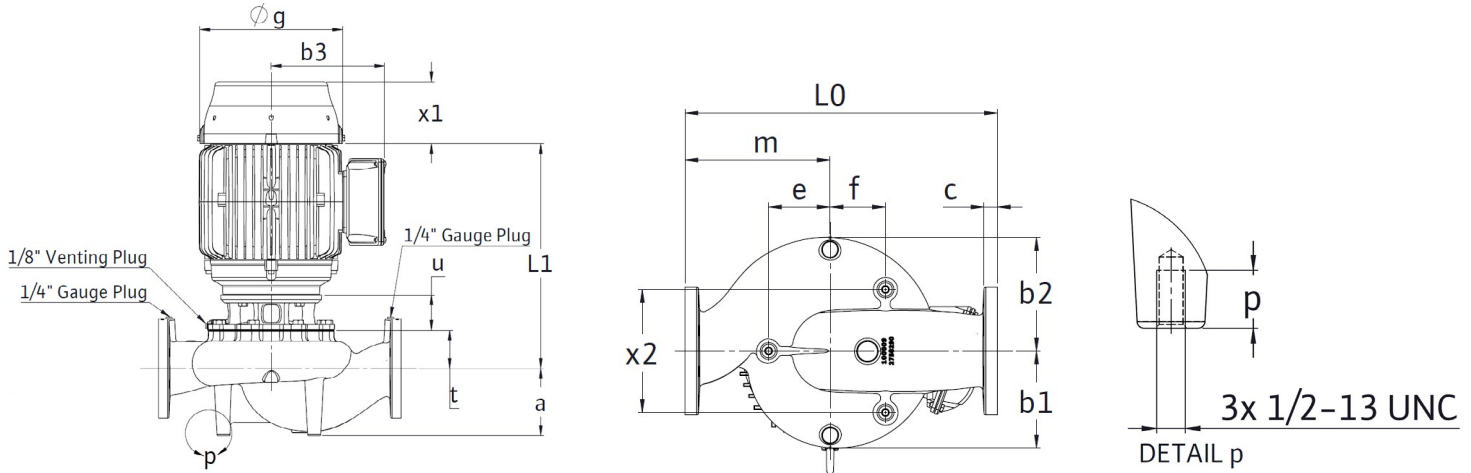

#### Dimensions and Weights

Dimensions- Inches (mm)

Model	Dia.	L0	a	b <sub>1</sub>	b <sub>2</sub>	b <sub>3</sub>	c	e	f	Øg	L1	m	p	t	u	x1	x2	Weight
ICL 4X4X8.86-TEFC-4-3-184TCZ-460-DI	4	22	6 1/8	6 33/16	8	7 1/2	1 1/4	4 5/16	3 7/8	8 15/16	15 11/16	10 3/4	1	3 7/16	3 3/16	4 1/16	8 11/16	285 lbs
	4	(559)	(155)	(173)	(203)	(191)	(32)	(110)	(99)	(227)	(398)	(260)	(25)	(88)	(81)	(103)	(220)	129 kg
ICL 4X4X8.86-TEFC-4-5-184TCZ-460-DI	4	22	6 1/8	6 33/16	8	7 9/16	1 1/4	4 5/16	3 7/8	8 35/16	15 11/16	10 3/4	1	3 7/16	3 3/16	4 1/16	8 11/16	305 lbs
	4	(559)	(155)	(173)	(203)	(192)	(32)	(110)	(99)	(227)	(398)	(260)	(25)	(88)	(81)	(103)	(220)	138 kg
ICL 4X4X8.86-TEFC-4-7.5-215TCZ-460-DI	4	22	6 1/8	6 33/16	8	8 5/8	1 1/4	4 5/16	3 7/8	10 3/4	18 1/4	10 3/4	1	3 7/16	3 3/16	4 9/16	8 11/16	365 lbs
	4	(559)	(155)	(173)	(203)	(219)	(32)	(110)	(99)	(273)	(464)	(260)	(25)	(88)	(81)	(116)	(220)	166 kg
ICL 4X4X8.86-TEFC-4-10-215TCZ-460-DI	4	22	6 1/8	6 33/16	8	8 5/8	1 1/4	4 5/16	3 7/8	10 3/4	18 3/4	10 3/4	1	3 7/16	3 3/16	4 1/2	8 11/16	370 lbs
	4	(559)	(155)	(173)	(203)	(219)	(32)	(110)	(99)	(273)	(464)	(260)	(25)	(88)	(81)	(115)	(220)	168 kg
ICL 4X4X8.86-TEFC-4-15-254TCZ-460-DI	4	22	6 1/8	6 33/16	8	10 7/16	1 1/4	4 5/16	3 7/8	12 15/16	20 3/8	10 3/4	1	3 7/16	3 3/16	5 5/8	8 11/16	470 lbs
	4	(559)	(155)	(173)	(203)	(265)	(32)	(110)	(99)	(329)	(518)	(260)	(25)	(88)	(81)	(142)	(220)	213 kg

#### EC Motor Data (Single Motor Operation)

Model	P2	Phase	Voltage
	[HP]	[-]	[V]
ICL 4X4X8.86-TEFC-4-3-184TCZ-460-DI	3	3	460
ICL 4X4X8.86-TEFC-4-5-184TCZ-460-DI	5	3	460
ICL 4X4X8.86-TEFC-4-7.5-215TCZ-460-DI	7.5	3	460
ICL 4X4X8.86-TEFC-4-10-215TCZ-460-DI	10	3	460
ICL 4X4X8.86-TEFC-4-15-254TCZ-460-DI	15	3	460

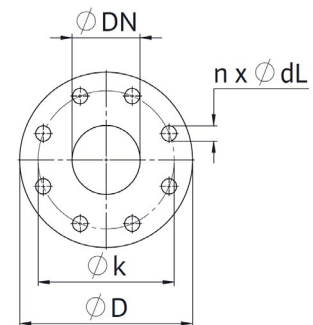

#### Flange Dimensions

Dimensions- Inches (mm)			
DN	ØD	Øk	nx ØdL
4	10 (254)	7 7/8 (200)	8x Ø7/8 8x (22)

Wilo USA

T +1 888 945 6872  
F +1 888 945 6873  
www.wilo-usa.com  
info@wilo-usa.com

Wilo Canada Inc.

T +1 866 945 6236  
F +1 403 277 9456  
www.wilo-canada.com  
info@wilo-canada.com

Wilo Mexico

T +52 55 5586 3209  
F +52 1 55 5413 4165  
www.wilo-mexico.com.mx  
info@wilo.com.mx